

19mm (3/4") stud

part number **SSFISS19**

weight 16g (1oz)

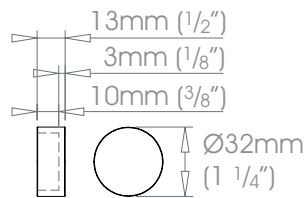

25mm (1") stud

part number **SSFISS25**

weight 38g (1oz)

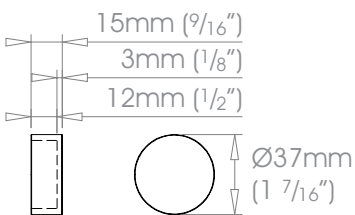

30mm (1 3/16") stud

part number **SSFISS30**

weight 51g (2oz)

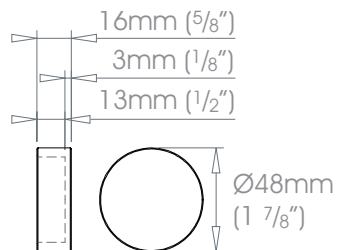

38mm (1 1/2") stud

part number **SSFISS38**

weight 100g (4oz)

colour finish number add selected finish number to the above part number
brushed - 068 • shot+ - 069

+ a handling charge per order will apply **shot finish - important handling information** - please note that this is a delicate surface finish that requires careful handling.

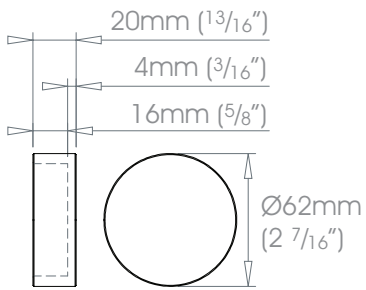

50mm (2") stud

part number **SSFISS50**



weight 198g (7oz)

colour finish number add selected finish number to the above part number
brushed - 068 • shot+ - 069

+ a handling charge per order will apply **shot finish – important handling information** - please note that this is a delicate surface finish that requires careful handling.