

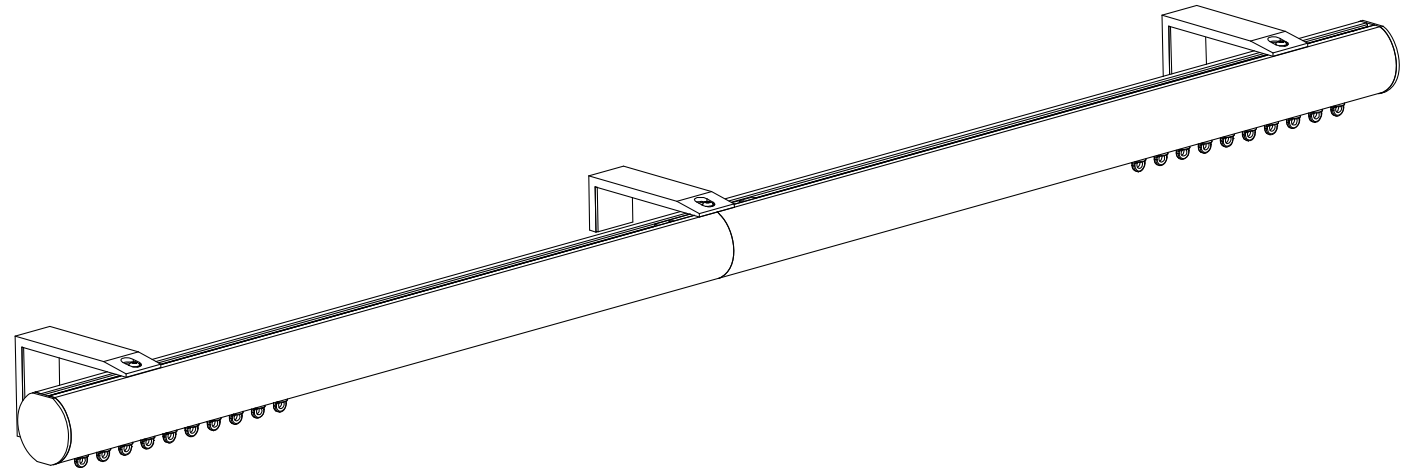

the**bradley**collection

GLIDERPOLE®
HAND DRAWN • CORDED

Installation Instructions



CONTACT

Web www.bradleycollection.com

Email info@bradleycollection.com

Follow     

WORLD

The Bradley Collection Ltd
Lion Barn • Maitland Road
Needham Market • Suffolk
IP6 8NS • UK

Telephone +44 (0)1449 722 724

Fax +44 (0)1449 722 728

USA & Canada

The Bradley Collection Inc.
3625 Hayden Avenue, Suite E
Culver City • CA • 90232 • USA

Telephone +1 (310) 815 8255

Fax +1 (310) 815 9255

GLIDERPOLE® HAND DRAWN & CORDED

Installation Instructions

THANK YOU FOR YOUR ORDER

Before fitting this product please ensure that you have thoroughly read these instructions.

We have taken every care to design and manufacture a quality system; incorrect installation could lead to poor performance.

If any queries arise when reviewing these instructions or during installation please feel free to contact us for assistance. We will be glad to talk you through the process.

Please retain these instructions for future reference.

CONTACT

Web www.bradleycollection.com

Email info@bradleycollection.com

World +44 (0)1449 722 724

USA & Canada +1 (310) 815 8255

Follow     

Fixings

As a courtesy we have supplied a set of fixings for the system.

These screws and wall plugs are designed to be used in wood and brick walls. We understand our systems may be used on a variety of materials; drywall, aluminium and steel stud, or lath and plaster.

To properly secure a system onto these or other types of surfaces; appropriate fixings must be independently obtained.

! Assess your own wall construction and source the appropriate screw type.
! Please note that the enclosed fixings may not be suitable for all wall types.

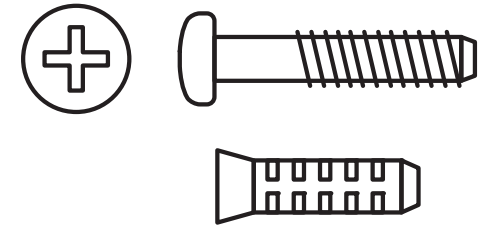

Tools

For the installation of the system the following items may be required.

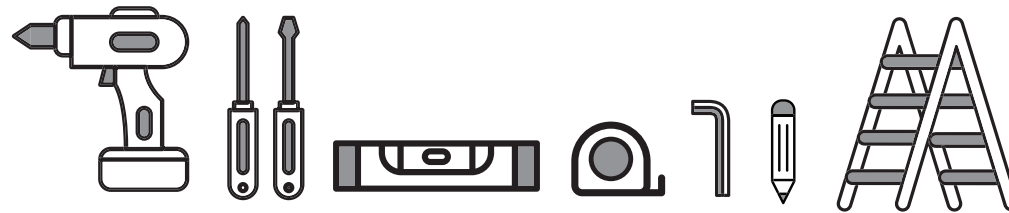

Care & Maintenance

This gliderpole can be cleaned using a soft cloth and furniture polish.

! Please do not use any solvent or chlorine based cleaners as this will damage the finish.

Bracket positioning and fixing

Side brackets should be positioned approximately 100mm (4") in from the end of the gliderpole.

Single Brackets

To align the brackets, the top of the mid brackets should be fitted inline with the top of the side brackets.

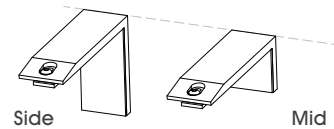

Exploded
bracket
assembly

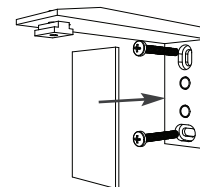

Bracket Positioning & Fixing

Side brackets should be positioned approximately 100mm (4") from the ends of the pole.

Mark the position of the brackets. for longer poles a mid bracket is required.

Drill holes & insert plugs.

Screw each bracket into position.

Push cover plate over arm, the cover is held in place by magnets.

Flat • 30mm (1 3/16") • 50mm (2") Gliderpoles

T-bars are pre-installed into the poles, spare T-bars are supplied in with the brackets.

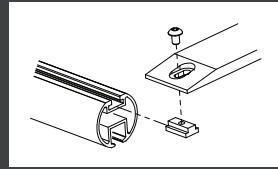

Square Gliderpole

Swivel Clamps are pre-attached to the brackets.

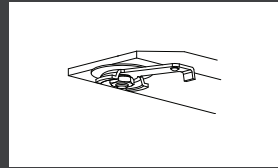

Fitting Gliderpole to the Brackets

Flat • 30mm (1 3/16") • 50mm (2") Gliderpoles

Offer the gliderpole up to the bracket, and tighten the button head screw into the t-bar, ensuring that the pole is fully secured. Making sure that the overhangs at each end are equal.

If the gliderpole is made of two connected lengths, the mid bracket should be fitted on the join.

Square Gliderpoles

Offer the gliderpole up to the bracket, and turn the swivel clamps until there is a positive click.

Making sure that the overhangs at each end are equal.

If the gliderpole is made of two connected lengths, the mid bracket should be fitted on the join.

When fitting the track ensure the higher edge of the profile is at the front.



Adding and removing gliders/rollers

Gliderpoles are supplied with gliders/rollers pre-installed, in some instances it may be necessary to add or remove gliders, to do this follow the steps overleaf

Hand drawn

A stop eyelet is provided at the end of the gliderpole, this allows the curtain to be hung all the up to the finial.

Corded

there is a trapped glider/roller in the cording block at the end of the gliderpole, this allows the curtain to be hung all the up to the finial and to hide the control cord.

Joining the Gliderpole

Gliderpoles are supplied pre-cut to your specified lengths, in some cases the gliderpole may be made in two or more parts, joined by a connector.

Push the joiner* into the pole ends and push the gliderpoles together. tighten the set screws in the top channel of the profile

Please note, if there is a gap between joins gliders/rollers may not run efficiently.

* Internal joiner will vary between gliderpole type and diameter.

Finials

Attach the finials by pushing them into position and tightening the set screws on the finial.

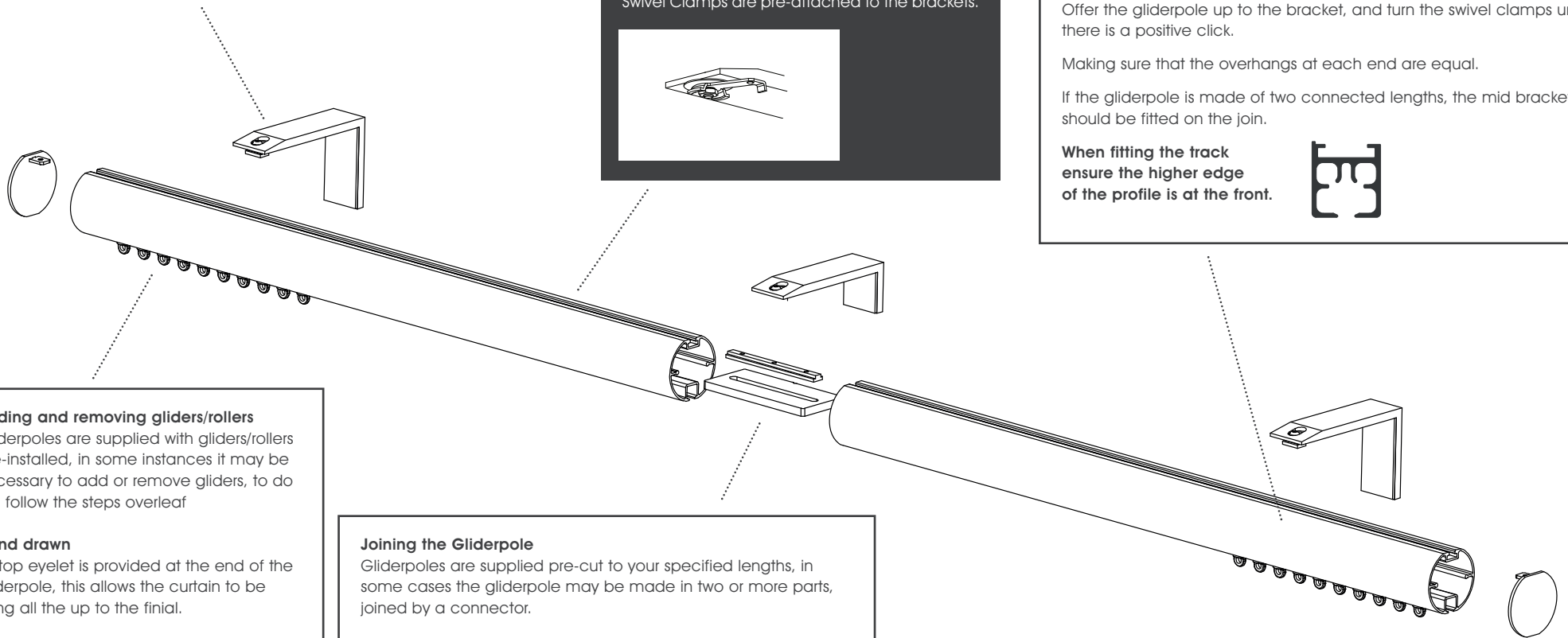

Adjustable Brackets

Mark the position of the brackets. for longer poles a mid bracket is required.

Drill holes & insert plugs.

Screw each bracket into position.

Push cover plate over arm, the cover is held in place by magnets.

Screw in the button head screws into the bracket arm and slide to the desired projection, once the projection is set tighten the screws to ensure the bracket arm is firmly secure.

Offer the gliderpole up to the bracket, and tighten the button head screw into the t-bar, ensuring that the pole is fully secured.

Please note, all joints must be supported by a bracket. where poles join, substitute the t-bar for a joiner

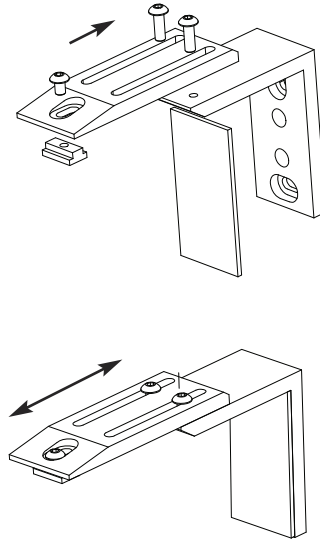

Light Duty Ceiling Brackets - Suitable for use with flat and 30mm gliderpoles

Mark the position of the brackets. for longer gliderpoles additional brackets are required.

Drill holes & insert plugs.

Locate t-bar into the top of the pole & tighten the counter sunk screw.

Screw each bracket into position.

Please note, bracket must be secured to the gliderpole before being fitted to the ceiling. all joints must be supported by a bracket. where gliderpoles join, substitute the t-bar for a joiner

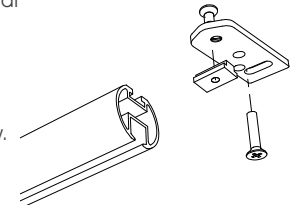

Heavy Duty Ceiling Brackets - Suitable for use with all gliderpole types

Mark the position of the brackets. For longer poles additional brackets are required.

Drill holes & insert plugs.

Locate t-bar into the top of the pole & tighten the counter sunk screw.

Screw each bracket into position.

Please note, bracket must be secured to the gliderpole before being fitted to the ceiling. All joints must be supported by a bracket. Where gliderpoles join, substitute the t-bar for a joiner

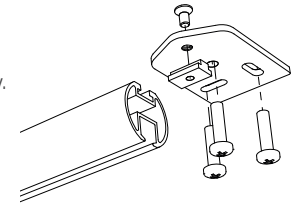

Double bridge

Locate t-bar into the top of the pole & tighten the counter sunk screw

Offer the gliderpole up to the bridge, and tighten the button head screws into the t-bars, ensuring that the pole is fully secured.

Tighten setscrew in the center of the bridge to fix the projection on the rear pole.

Please note, where poles join, substitute the two t-bars for a joiner

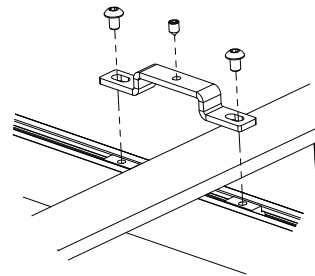

Recess brackets

1. Use a suitable wall fixing when attaching the plate to the wall.
2. Slide the locking tab inside the top of the pole up in to the fix plate.
3. Tighten the setscrew in both the top of the bracket and top channel of the pole.

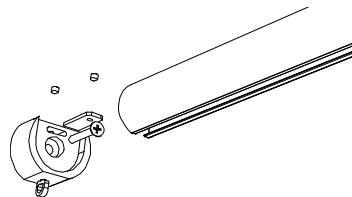

Adjustable & Stand-off Ceiling Brackets - Suitable for use with all gliderpole types

Mark the position of the brackets. for longer poles additional brackets are required.

Drill holes & insert plugs.

Screw each bracket into position.

Locate t-bar into the top of the pole & screw the post into the t-bar, until secure.

Offer the gliderpole up to the ceiling, the post should slide into fixing, when at the desired projection from the ceiling tighten the grub screw on the fixing, ensuring that the pole is fully secured.

Please note, please note, all joints must be supported by a bracket. where gliderpoles join, substitute the t-bar for a joiner

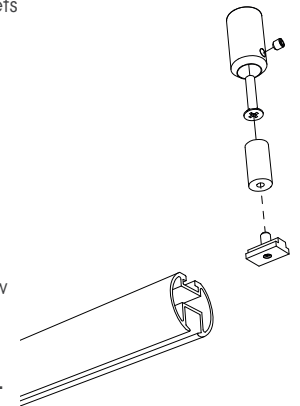

Adding and Removing Gliders/Rollers

Gliderpoles are supplied with gliders/rollers pre-installed, in some instances it may be necessary to add or remove gliders, to do this follow the steps below

Hand Drawn

Before fitting the finial or flush end cap add/remove gliders or rollers from the bottom channel. If using wave ensure that there is an even number or wave gliders/rollers on each stack

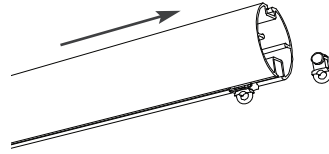

Corded

Locate and remove the spring stop in the bottom channel of the track.

Add/remove gliders or rollers from the bottom channel. If using wave ensure that there is an even number or wave gliders/rollers on each stack

Refit the spring stop.

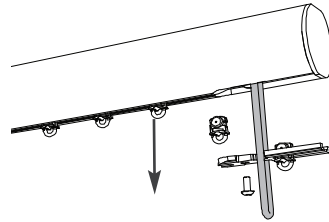

! CORDED GLIDERPOLES WARNING

Young children can be strangled by loops in pull cords, chains, tapes and inner cords that operate the product.

To avoid strangulation and entanglement, keep cords out of the reach of young children. cords may become wrapped around a child's neck.

Move beds, cots and furniture away from window covering cords.

Do not tie cords together.

Make sure cords do not twist and create a loop.

Children can be strangled if this safety device is not installed.

Always use this device to keep cords or chains out of the reach of children.

This retaining device should be installed at the maximum distance possible from the control mechanism to prevent the looped pull cord(s) becoming slack.

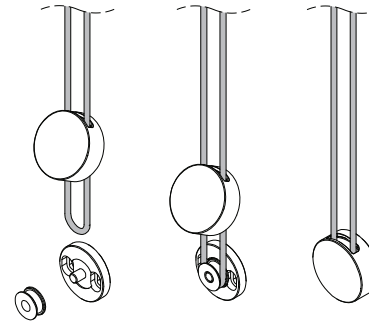

Mark and drill holes for the fixing plate.

Put pulley wheel onto fixing plate. Feed cord through the cover plate and pull into position.

Slide coverplate down and locate over fixing plate. tighten grub screw on the underside.