

FLOAT

THE **BRADLEY**
COLLECTION

SPECIFICATION GUIDE

FLOAT

SPECIFICATION GUIDE

This specification guide was designed to outline the main considerations that need to be made when quoting or ordering a system.

If any questions arise please call your local sales representative or contact The Bradley Collection directly.

System Information Page 3-12

POLES Page 4

JOINTING SYSTEM Page 5

BAYS & MINIMUM WALL SIZES Page 6

BRACKET ALIGNMENT Page 7

CUSTOM BRACKETS Page 8

CURTAIN DROPS Page 9-11

POLE CONFIGURATION Page 12

Finishes Page 13-16

Finials Page 17-27

Poles Page 28-32

Brackets Page 33-42

Rings Page 43-44

Accessories Page 45-47

**THE BRADLEY
COLLECTION**

FLOAT

Poles are cut, bent and curved to suit individual requirements. When calculating the length of your pole, remember to allow tolerance beyond the width of the frame for the curtains to draw back to the edge of the window.

Maximum pole length in one piece 4.0m (157").

Poles exceeding the maximum length will be cut into equal parts unless otherwise specified.

Joining system will be supplied. (See page 5) Brackets should be placed at every join.

Ø30mm (1 3/16") • 38mm (1 1/2")

The overall pole cost is rounded up in 300mm (1ft) increments.

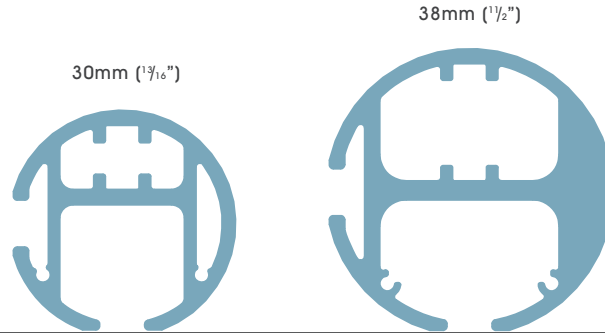

Diameter	Maximum distance between brackets	Minimum bend radius
Ø30mm (1 3/16")	1000mm (39")	R300mm (12")
Ø38mm (1 1/2")	1000mm (39")	R400mm (16")

PROVIDING POLE LENGTHS

Pole lengths can be specified in two ways.

OPTION A is our preferred method. This covers Pole length only. **OPTION B** combines pole and finial lengths.

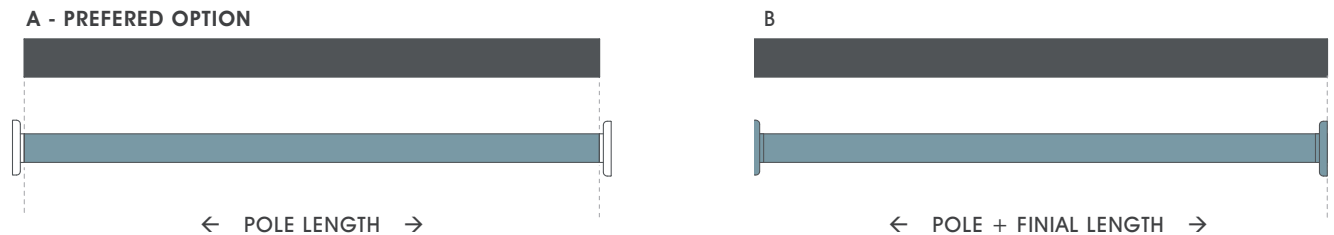

*Section lengths over 2.4m (94") will incur a handling charge ☼ Acrylic poles should not be positioned in direct sunlight, and are not suitable for use in conservatories or outdoors

FLOAT

JOINTING SYSTEM

Float's jointing system ensures perfect alignment between pole sections.

Joints must always be supported by a bracket.

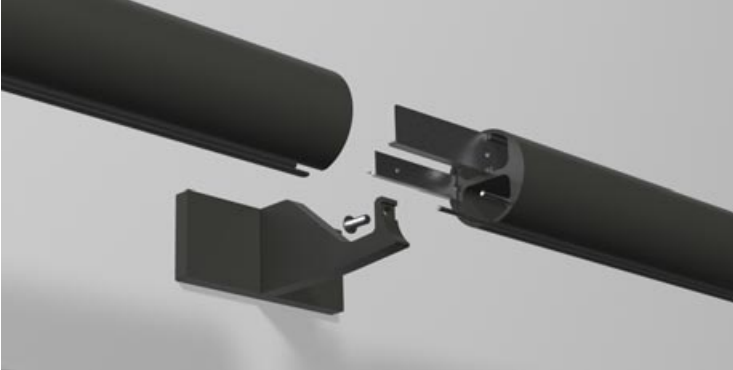

30mm (1 3/16")

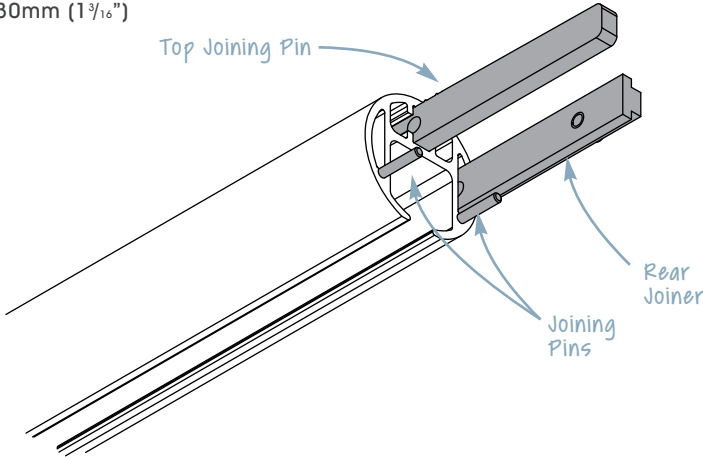

38mm (1 1/2")

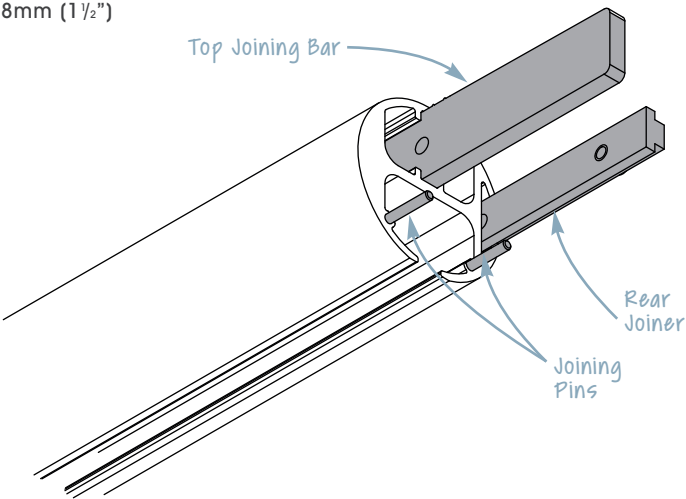

Bradley's bespoke service allows poles to be specifically made for unique bay windows and complex long span installations. Poles can be shaped to create a system that follows contours.

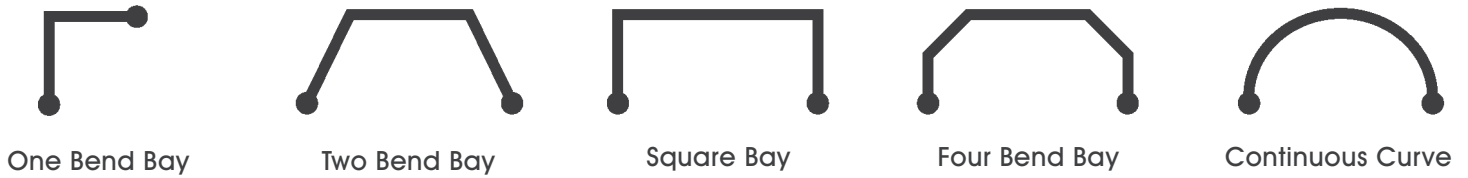

! Return bends are not available.

MINIMUM WALL SIZES

135° Bend Angles

90° Bend Angles

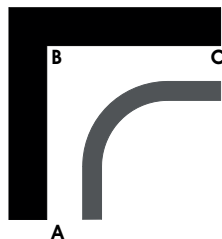
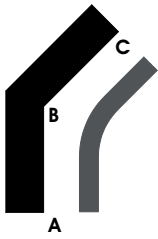

Diameter	Wall A - B	Wall B - C	Angle at B	Minimum Bend Radius	Minimum Projection
∅30mm (1 ³ / ₁₆ "	216mm (8 ¹ / ₂ "	216mm (8 ¹ / ₂ "	135°	300mm (12"	60mm (2 ³ / ₈ "
∅30mm (1 ³ / ₁₆ "	450mm (17 ¹ / ₁₆ "	450mm (17 ¹ / ₁₆ "	90°	300mm (12"	60mm (2 ³ / ₈ "
∅38mm (1 ¹ / ₂ "	316mm (12 ⁷ / ₁₆ "	316mm (12 ⁷ / ₁₆ "	135°	400mm (16"	100mm (4"
∅38mm (1 ¹ / ₂ "	550mm (21 ⁵ / ₈ "	550mm (21 ⁵ / ₈ "	90°	400mm (16"	100mm (4"

BRADLEY BAY CHECKER +

Bay Checker + is part of our Digital Toolbox, allowing you to check your measurement for bays and curves whilst onsite, as well as storing straight window dimensions for your projects.

Unlimited measurements may be saved locally to your device or shared to your colleagues.

Available as a free download for iOS or Android,

For more information on Bay Checker + and latest enhancements to our Digital Toolbox visit

www.bradleycollection.com/digital-toolbox/

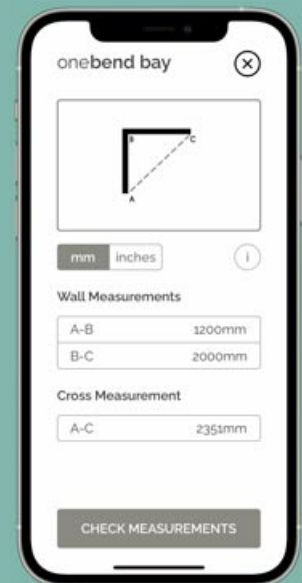

The information below shows the relationship between the bracket backplate. this will enable easy alignments during instalation.

SINGLE SYSTEM - $\varnothing 30\text{mm}$ ($1\frac{3}{16}$ "

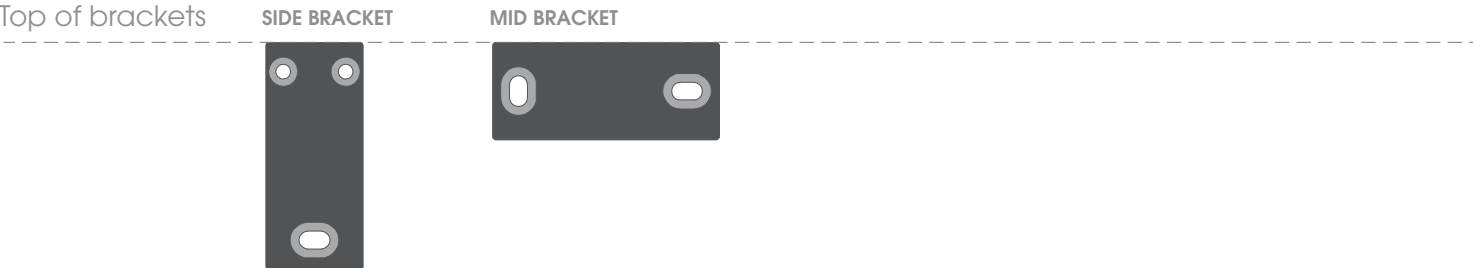

SINGLE SYSTEM - $\varnothing 38\text{mm}$ ($1\frac{1}{2}$ "

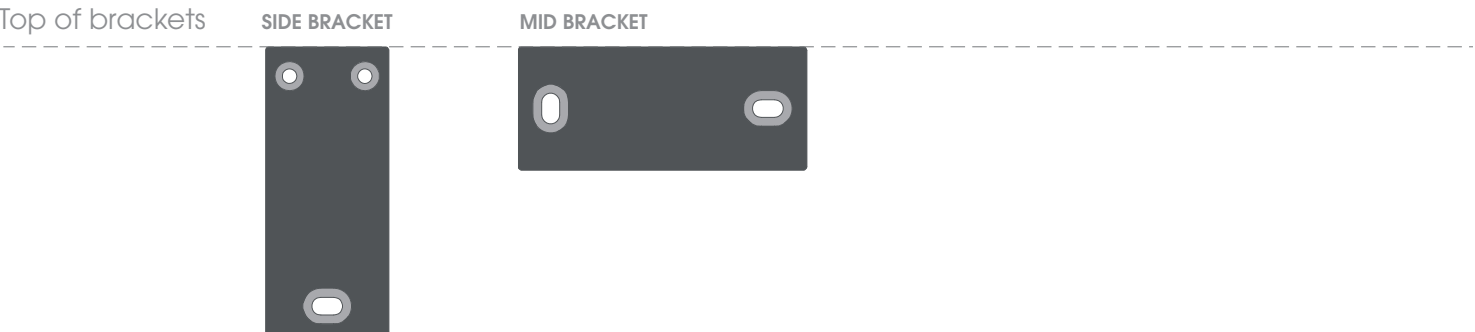

DOUBLE SYSTEMS

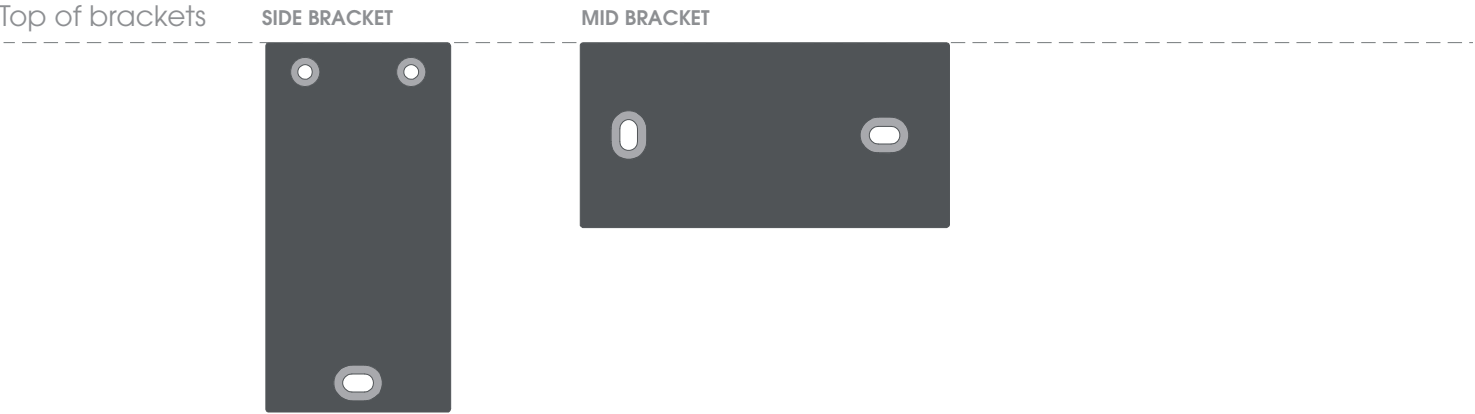

Float can be customised to suit virtually any window. For simple projection changes between the Minimums and Maximums listed below brackets are charged at double their standard costs. For all other customisations an additional custom fee is applied per drawing



Custom Projection
Specify the exact projection needed.



Custom Fixing Plate
Relevant where space is restricted or weight is a concern.



Uplift
Helps negotiate cornice and similar architectural features.



Ceiling Brackets
Specify exact projection required from ceiling.



Angled Brackets
The solution for tight and awkward locations.

Minimum & Maximum Bracket Projections

Dimensions outside of these stated min/max projections may still be possible but will generate a design charge per drawing. See pricelist for details

Diameter	Type	Standard Projection(s)	Minimum Projection	Maximum Projection
∅30mm (1 ³ / ₁₆ "	Side	60mm (2 ³ / ₈ " • 100mm (4")	70mm (2 ³ / ₄ "	200mm (8")
∅30mm (1 ³ / ₁₆ "	Mid	60mm (2 ³ / ₈ " • 100mm (4")	70mm (2 ³ / ₄ "	200mm (8")
∅38mm (1 ¹ / ₂ "	Side	100mm (4")	83mm (3 ¹ / ₄ "	200mm (8")
∅38mm (1 ¹ / ₂ "	Mid	100mm (4")	83mm (3 ¹ / ₄ "	200mm (8")

The information below shows the relationship between the pole, brackets and rings.
 This will enable the correlation between pole heights and curtain drops to be easily calculated.

 Rings sit 5mm ($\frac{3}{16}$ ") above the pole

SINGLE SYSTEM - $\varnothing 30\text{mm}$ ($1\frac{3}{16}$ ")

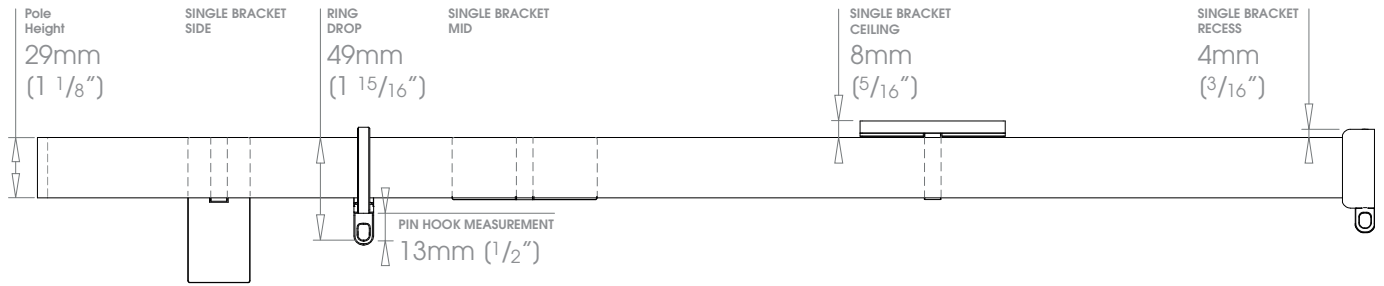

DOUBLE SYSTEM - FRONT $\varnothing 30\text{mm}$ ($1\frac{3}{16}$ ") BACK $\varnothing 30\text{mm}$ ($1\frac{3}{16}$ ")

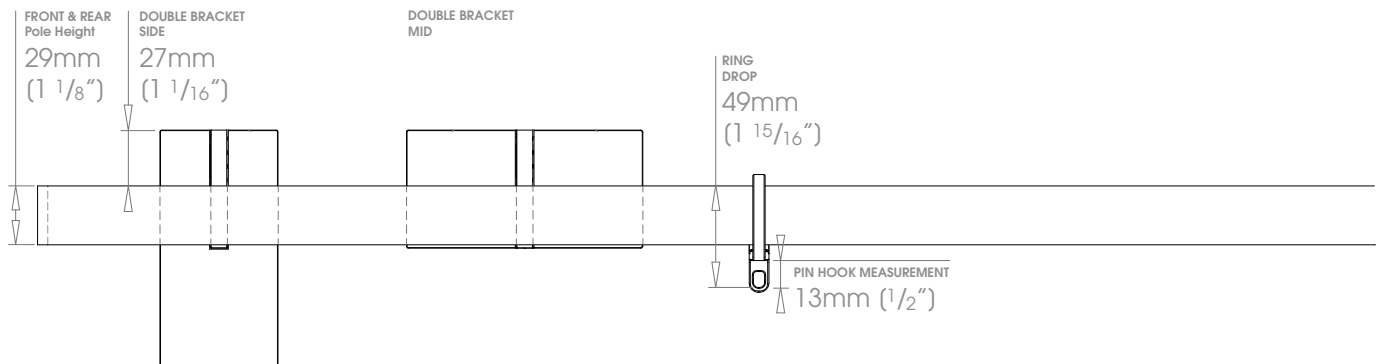

The information below shows the relationship between the pole, brackets and rings.
This will enable the correlation between pole heights and curtain drops to be easily calculated.

 Rings sit 5mm ($\frac{3}{16}$ ") above the pole

SINGLE SYSTEM - $\varnothing 38\text{mm}$ ($1\frac{1}{2}$ ")

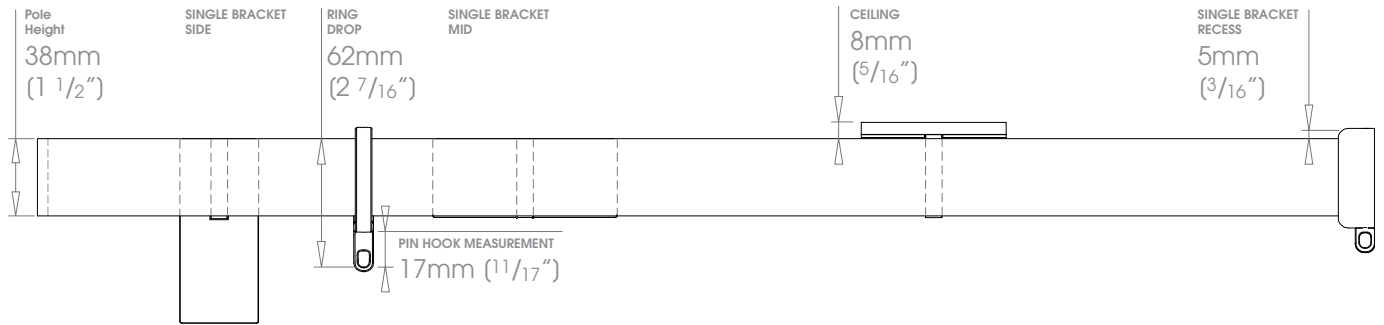

DOUBLE SYSTEM - FRONT $\varnothing 38\text{mm}$ ($1\frac{1}{2}$ ") BACK $\varnothing 30\text{mm}$ ($1\frac{3}{16}$ ")

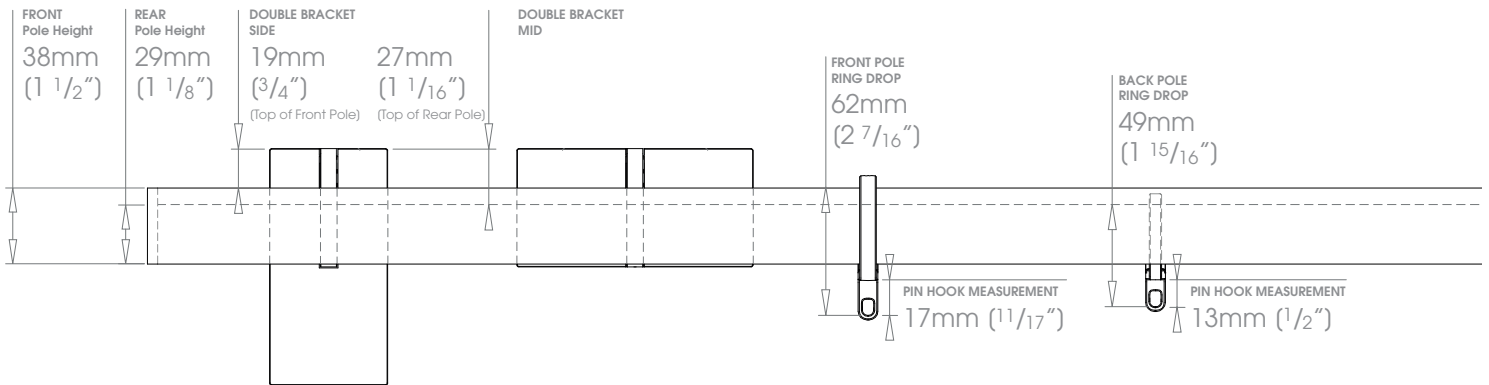

DOUBLE SYSTEM - FRONT $\varnothing 38\text{mm}$ ($1\frac{1}{2}$ ") BACK $\varnothing 38\text{mm}$ ($1\frac{1}{2}$ ")

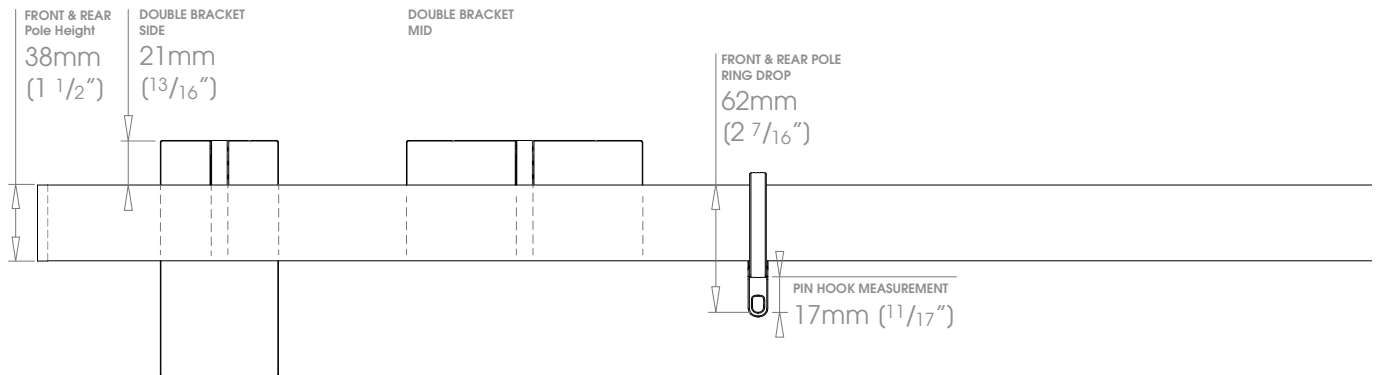

The information below shows the relationship between the pole, brackets and rings.
This will enable the correlation between pole heights and curtain drops to be easily calculated.



Partition Brackets can not be used around bay windows

DOUBLE PARTITION SYSTEM - FRONT $\varnothing 30\text{mm}$ ($1\frac{3}{16}$ ") BACK $\varnothing 30\text{mm}$ ($1\frac{3}{16}$ ")

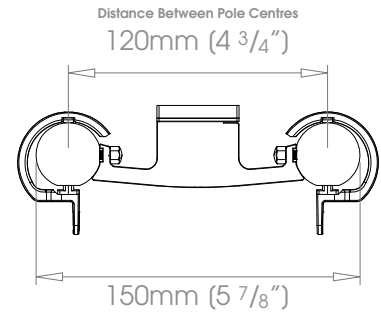
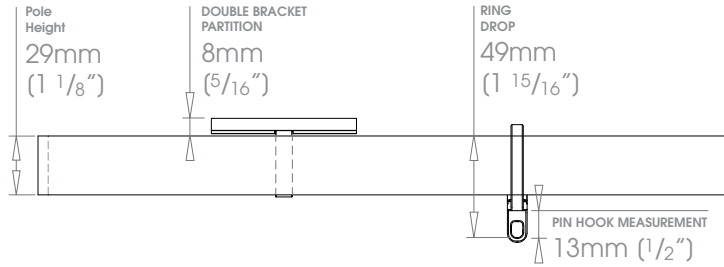

DOUBLE PARTITION SYSTEM - FRONT $\varnothing 38\text{mm}$ ($1\frac{1}{2}$ ") BACK $\varnothing 38\text{mm}$ ($1\frac{1}{2}$ ")

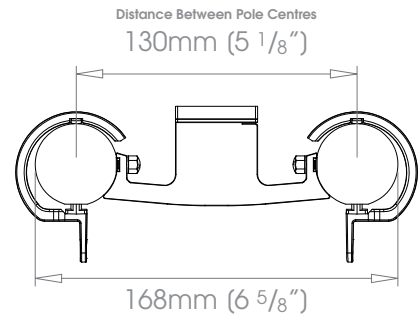
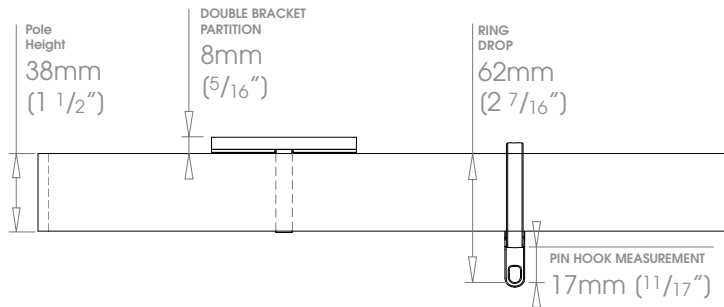

FLOAT

POLE CONFIGURATION

Systems will be supplied as per the diagrams below.

GLIDER ACCESS

For single stack curtains a glider access point will be positioned the same side as the curtain stack.

For pair stack curtains the access point will be positioned on the right hand side, unless otherwise requested.

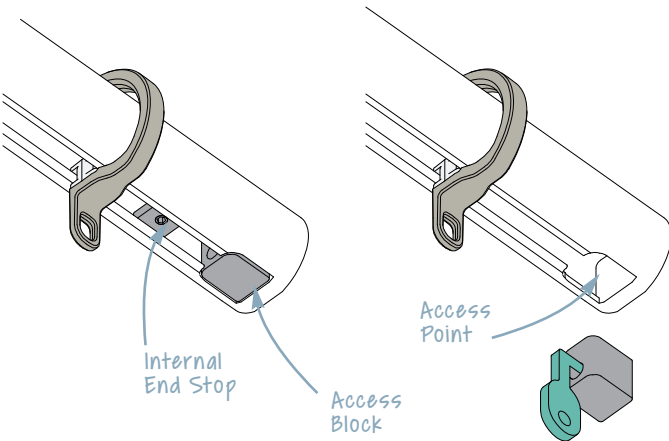

T-BAR ACCESS

For poles made in one piece, a T-Bar access point will positioned on the righthand side

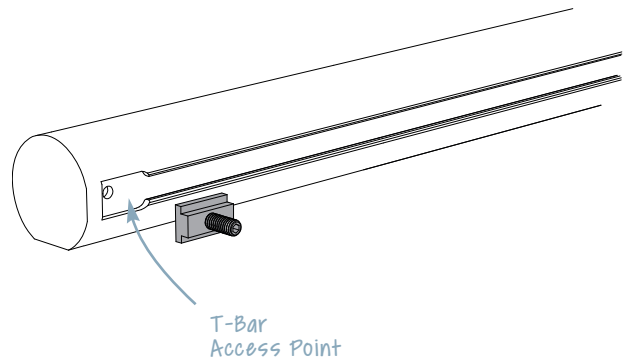

FLOAT POLE SYSTEMS

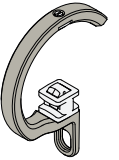

SINGLE STACK →

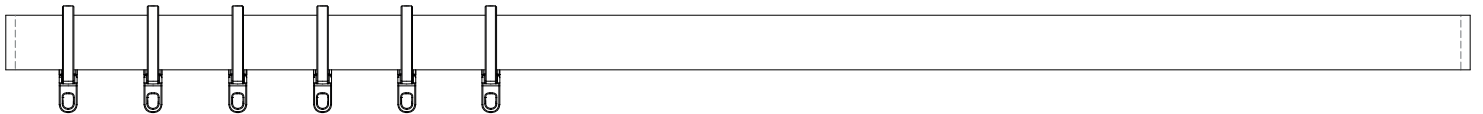

SUPPLIED WITH

1x Internal End Stop • 1x Glider Access Block (Glider access will be positioned the same side as curtain stack)

PAIR STACK →←

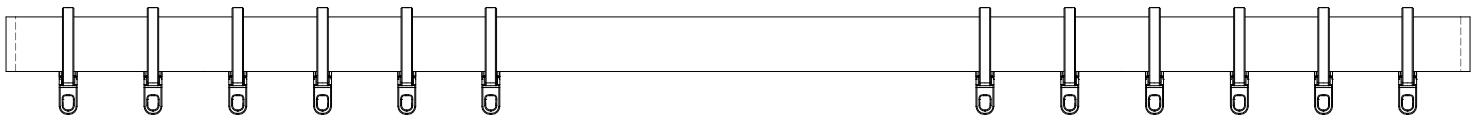

SUPPLIED WITH

2x Internal End Stop • 1x Glider Access Block (Glider access will be positioned as standard on the right hand side)

FLOAT

FINISHES

All poles and components may be specified in this stunning palette of colours and finishes, with a choice of coat options throughout.

COAT OPTIONS



SHADES

A superb selection of opaque colours, all available in a choice of Matte, Satin or Gloss finish.

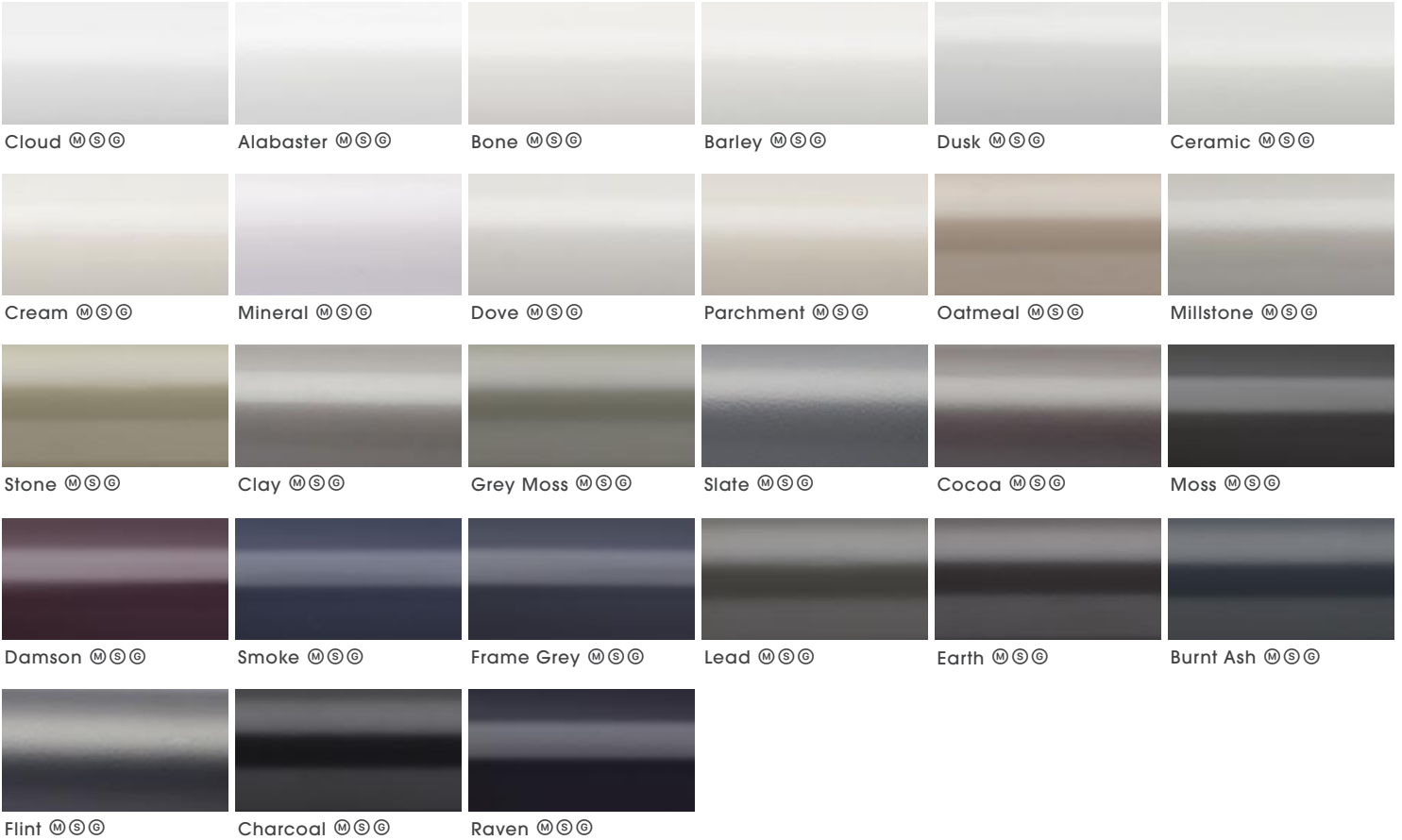

All poles and components may be specified in this stunning palette of colours and finishes, with a choice of coat options throughout.

COAT OPTIONS

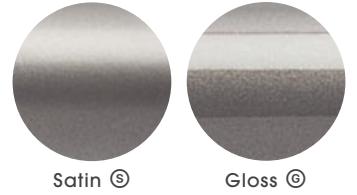

METALLICS

High metallic fleck coatings with most available in Satin and Gloss sheen levels.

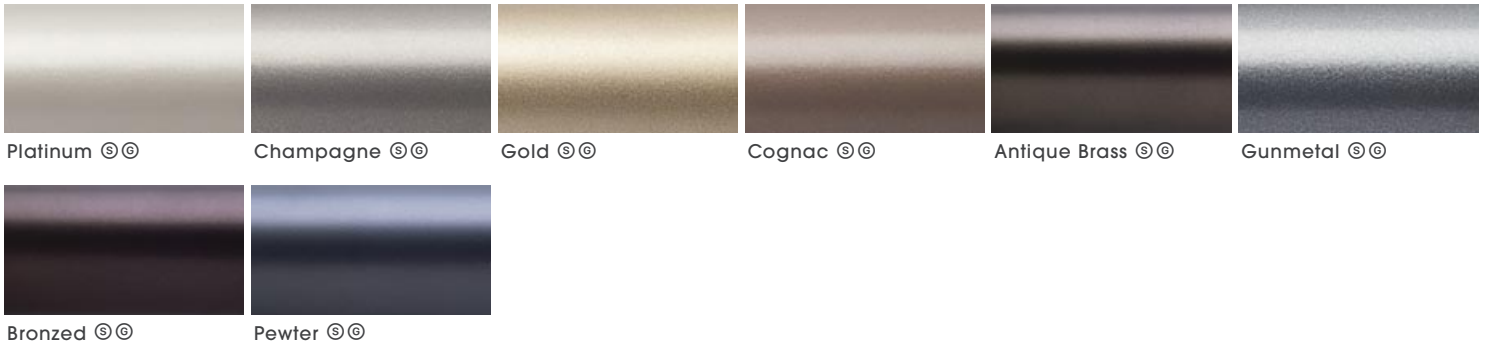

ANODIC METALS

A flat metal colour group, with an anodised style surface texture.

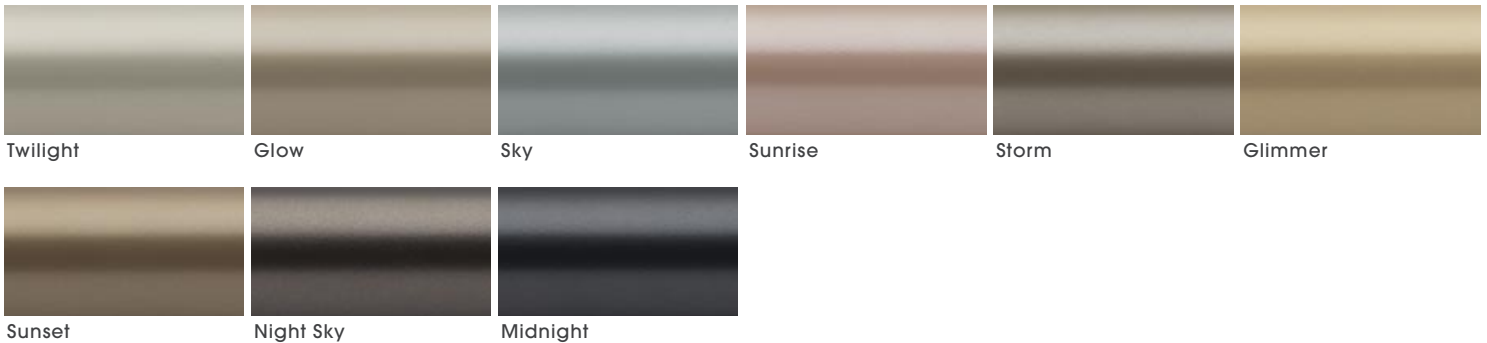

CUSTOM FINISHES

Can be specified from RAL K7 finish chart, subject to a per colour upcharge, which covers up to five poles. See pricelist for further details





COLOUR MATCHING

A colour matching service is offered, to match your scheme of fittings perfectly. See pricelist for further details

Rings will be supplied with Gliders & Liners in either Gypsum or Anthracite. See table below

Coat Options Matte[Ⓜ] • Satin[Ⓢ] • Gloss[ⓖ]

System Finish	Gypsum 	Anthracite 
Alabaster ^{ⓂⓈⓖ}	✓	
Antique Brass ^{ⓂⓈ}		✓
Barley ^{ⓂⓈⓖ}	✓	
Bone ^{ⓂⓈⓖ}	✓	
Burnt Ash ^{ⓂⓈⓖ}		✓
Bronzed ^{ⓂⓈ}		✓
Ceramic ^{ⓂⓈⓖ}	✓	
Champagne ^{ⓂⓈ}		✓
Charcoal ^{ⓂⓈⓖ}		✓
Clay ^{ⓂⓈⓖ}		✓
Cloud ^{ⓂⓈⓖ}	✓	
Cocoa ^{ⓂⓈⓖ}		✓
Cognac ^{ⓂⓈ}		✓
Cream ^{ⓂⓈⓖ}	✓	
Damson ^{ⓂⓈⓖ}		✓
Dove ^{ⓂⓈⓖ}	✓	
Dusk ^{ⓂⓈⓖ}	✓	
Earth ^{ⓂⓈⓖ}		✓
Flint ^{ⓂⓈⓖ}		✓
Frame Grey ^{ⓂⓈⓖ}		✓
Glimmer		✓
Glow		✓
Gold ^{ⓂⓈ}		✓
Grey Moss ^{ⓂⓈⓖ}		✓
Gunmetal ^{ⓂⓈ}		✓
Lead ^{ⓂⓈⓖ}		✓
Midnight		✓
Millstone ^{ⓂⓈⓖ}		✓
Mineral ^{ⓂⓈⓖ}	✓	
Moss ^{ⓂⓈⓖ}		✓
Night Sky		✓
Oatmeal ^{ⓂⓈⓖ}		✓
Parchment ^{ⓂⓈⓖ}	✓	
Pewter ^{ⓂⓈ}		✓
Platinum ^{ⓂⓈ}		✓
Raven ^{ⓂⓈⓖ}		✓
Slate ^{ⓂⓈⓖ}		✓
Sky		✓
Smoke ^{ⓂⓈⓖ}		✓
Stone ^{ⓂⓈⓖ}		✓
Storm		✓
Sunrise		✓
Sunset		✓
Twilight		✓

FLOAT

FINIALS



! The seamless finial is an integral part of the pole.
 If this is selected optional finials can not be added at a later date.

FINISHES Shades @@@ Cloud • Alabaster • Bone • Barley • Dusk • Ceramic • Cream • Mineral • Dove • Parchment • Oatmeal • Millstone • Stone • Clay • Grey Moss
 Slate • Cocoa • Moss • Damson • Smoke • Frame Grey • Lead • Earth • Burnt Ash • Flint • Chacoal • Raven
 Coat Options **Metallics** @@ Platinum • Champagne • Gold • Cognac • Antique Brass • Gunmetal • Pewter • Bronzed
Anodic Metals Twilight • Glow • Sky • Sunrise • Storm • Glimmer • Sunset • Night Sky • Midnight
 Matte @ **Custom** See page 15 for details
 Satin @
 Gloss @

30mm (1³/₁₆")

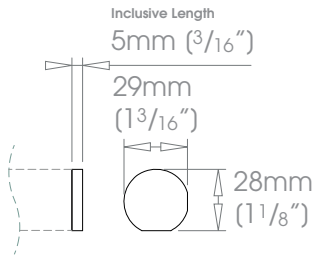

38mm (1¹/₂")

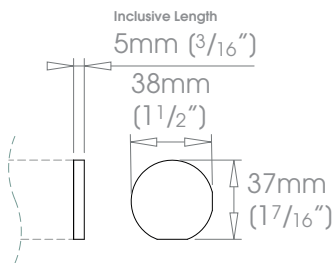



FINISHES **Shades** ☉☉☉ Cloud • Alabaster • Bone • Barley • Dusk • Ceramic • Cream • Mineral • Dove • Parchment • Oatmeal • Millstone • Stone • Clay • Grey Moss
 Slate • Cocoa • Moss • Damson • Smoke • Frame Grey • Lead • Earth • Burnt Ash • Flint • Chacoal • Raven
Coat Options **Metallics** ☉☉ Platinum • Champagne • Gold • Cognac • Antique Brass • Gunmetal • Pewter • Bronzed
Anodic Metals Twilight • Glow • Sky • Sunrise • Storm • Glimmer • Sunset • Night Sky • Midnight
Custom See page 15 for details
Matte ☉
Satin ☉
Gloss ☉

30mm (1 3/16")

38mm (1 1/2")

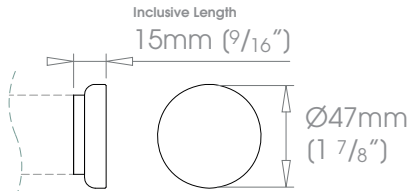
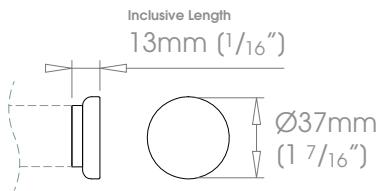



FINISHES Shades @@@ Cloud • Alabaster • Bone • Barley • Dusk • Ceramic • Cream • Mineral • Dove • Parchment • Oatmeal • Millstone • Stone • Clay • Grey Moss
 Slate • Cocoa • Moss • Damson • Smoke • Frame Grey • Lead • Earth • Burnt Ash • Flint • Chacoal • Raven
 Coat Options **Metallics** @@ Platinum • Champagne • Gold • Cognac • Antique Brass • Gunmetal • Pewter • Bronzed
Anodic Metals Twilight • Glow • Sky • Sunrise • Storm • Glimmer • Sunset • Night Sky • Midnight
Custom See page 15 for details
 Matte @
 Satin @
 Gloss @

30mm (1³/₁₆")

38mm (1¹/₂")

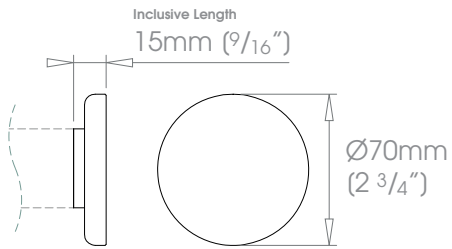
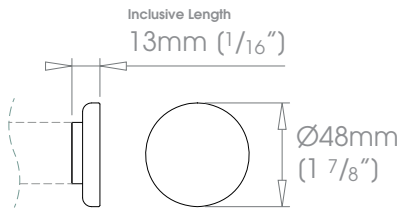



FINISHES Shades @@@ Cloud • Alabaster • Bone • Barley • Dusk • Ceramic • Cream • Mineral • Dove • Parchment • Oatmeal • Millstone • Stone • Clay • Grey Moss
 Slate • Cocoa • Moss • Damson • Smoke • Frame Grey • Lead • Earth • Burnt Ash • Flint • Chacoal • Raven
 Coat Options **Metallics** @@ Platinum • Champagne • Gold • Cognac • Antique Brass • Gunmetal • Pewter • Bronzed
Anodic Metals Twilight • Glow • Sky • Sunrise • Storm • Glimmer • Sunset • Night Sky • Midnight
Custom See page 15 for details
 Matte @
 Satin @
 Gloss @

30mm (1³/₁₆"

38mm (1¹/₂"

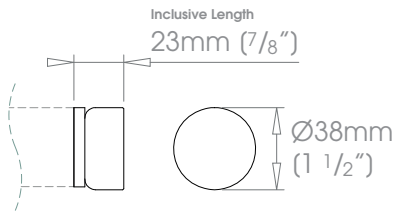
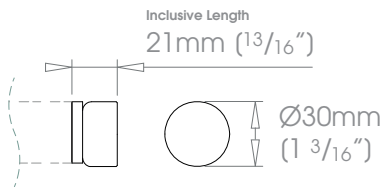



FINISHES Shades @@@ Cloud • Alabaster • Bone • Barley • Dusk • Ceramic • Cream • Mineral • Dove • Parchment • Oatmeal • Millstone • Stone • Clay • Grey Moss
 Slate • Cocoa • Moss • Damson • Smoke • Frame Grey • Lead • Earth • Burnt Ash • Flint • Chacoal • Raven
 Coat Options **Metallics** @@ Platinum • Champagne • Gold • Cognac • Antique Brass • Gunmetal • Pewter • Bronzed
Anodic Metals Twilight • Glow • Sky • Sunrise • Storm • Glimmer • Sunset • Night Sky • Midnight
Custom See page 15 for details
 Matte @
 Satin @
 Gloss @

30mm (1 3/16")

38mm (1 1/2")

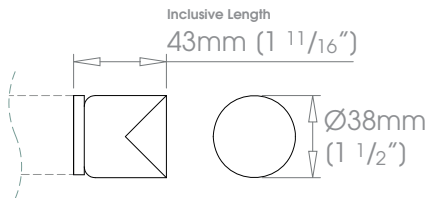
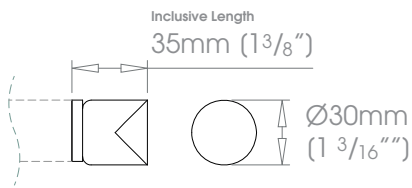



FINISHES **Shades** ☉☉☉ Cloud • Alabaster • Bone • Barley • Dusk • Ceramic • Cream • Mineral • Dove • Parchment • Oatmeal • Millstone • Stone • Clay • Grey Moss
 Slate • Cocoa • Moss • Damson • Smoke • Frame Grey • Lead • Earth • Burnt Ash • Flint • Chacoal • Raven
Coat Options **Metallics** ☉☉ Platinum • Champagne • Gold • Cognac • Antique Brass • Gunmetal • Pewter • Bronzed
Anodic Metals Twilight • Glow • Sky • Sunrise • Storm • Glimmer • Sunset • Night Sky • Midnight
Custom See page 15 for details
Matte ☉
Satin ☉
Gloss ☉

30mm (1³/₁₆"

38mm (1¹/₂"

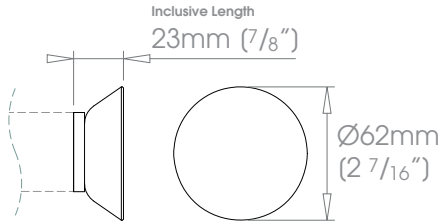
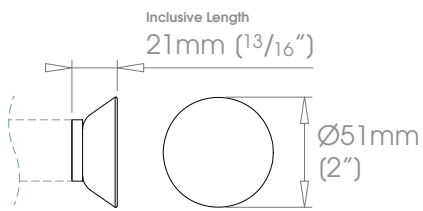



FINISHES **Shades** ☉☉☉ Cloud • Alabaster • Bone • Barley • Dusk • Ceramic • Cream • Mineral • Dove • Parchment • Oatmeal • Millstone • Stone • Clay • Grey Moss
 Slate • Cocoa • Moss • Damson • Smoke • Frame Grey • Lead • Earth • Burnt Ash • Flint • Chacoal • Raven
Coat Options **Metallics** ☉☉ Platinum • Champagne • Gold • Cognac • Antique Brass • Gunmetal • Pewter • Bronzed
Anodic Metals Twilight • Glow • Sky • Sunrise • Storm • Glimmer • Sunset • Night Sky • Midnight
Custom See page 15 for details
Matte ☉
Satin ☉
Gloss ☉

30mm (1³/₁₆"

38mm (1¹/₂"

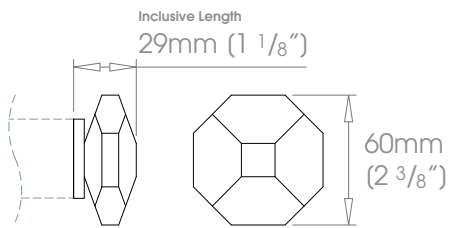
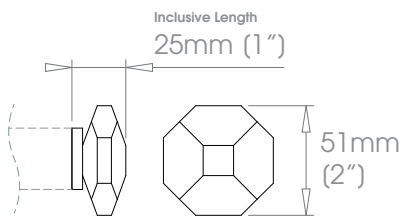



FINISHES **Shades** ☉☉☉ Cloud • Alabaster • Bone • Barley • Dusk • Ceramic • Cream • Mineral • Dove • Parchment • Oatmeal • Millstone • Stone • Clay • Grey Moss
 Slate • Cocoa • Moss • Damson • Smoke • Frame Grey • Lead • Earth • Burnt Ash • Flint • Chacoal • Raven
Coat Options **Metallics** ☉☉ Platinum • Champagne • Gold • Cognac • Antique Brass • Gunmetal • Pewter • Bronzed
Anodic Metals Twilight • Glow • Sky • Sunrise • Storm • Glimmer • Sunset • Night Sky • Midnight
Custom See page 15 for details
Matte ☉
Satin ☉
Gloss ☉

30mm (1³/₁₆"

38mm (1¹/₂"

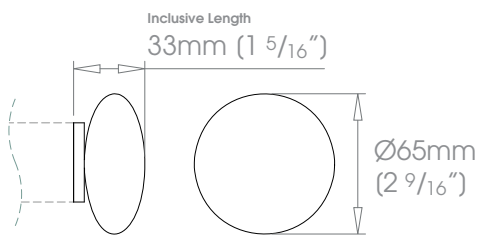
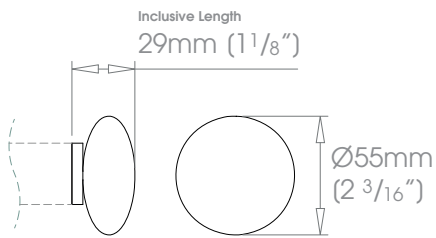



FINISHES **Shades** ☉☉☉ Cloud • Alabaster • Bone • Barley • Dusk • Ceramic • Cream • Mineral • Dove • Parchment • Oatmeal • Millstone • Stone • Clay • Grey Moss
 Slate • Cocoa • Moss • Damson • Smoke • Frame Grey • Lead • Earth • Burnt Ash • Flint • Chacoal • Raven
Coat Options **Metallics** ☉☉ Platinum • Champagne • Gold • Cognac • Antique Brass • Gunmetal • Pewter • Bronzed
Anodic Metals Twilight • Glow • Sky • Sunrise • Storm • Glimmer • Sunset • Night Sky • Midnight
Custom See page 15 for details
Matte ☉
Satin ☉
Gloss ☉

30mm (1³/₁₆")

38mm (1¹/₂")

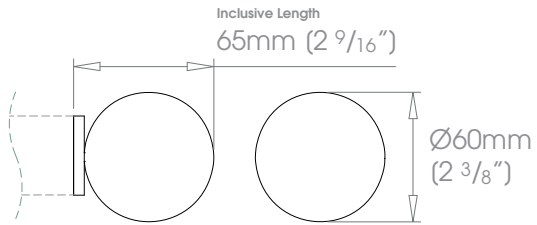
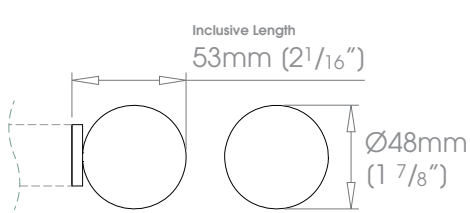

The following finials from our other collections can be specified on request.

MIO

For specific please refer to the Mio Specification Guide.

Final	Diameter(s)
Stud	∅30mm (1 ³ / ₁₆ ") • ∅38mm (1 ¹ / ₂ ")
Disc	∅30mm (1 ³ / ₁₆ ") • ∅38mm (1 ¹ / ₂ ")
Faceted Disc	∅30mm (1 ³ / ₁₆ ") • ∅38mm (1 ¹ / ₂ ")
Pebble	∅30mm (1 ³ / ₁₆ ") • ∅38mm (1 ¹ / ₂ ")
Squat Disc	∅30mm (1 ³ / ₁₆ ") • ∅38mm (1 ¹ / ₂ ")
Ball	∅30mm (1 ³ / ₁₆ ") • ∅38mm (1 ¹ / ₂ ")
Crystal Ball	∅30mm (1 ³ / ₁₆ ") • ∅38mm (1 ¹ / ₂ ")

ELYSIAN

For specific please refer to the Elysian Specification Guide.

Final	Diameter(s)
Halo	∅30mm (1 ³ / ₁₆ ") • ∅38mm (1 ¹ / ₂ ")
Aura	∅30mm (1 ³ / ₁₆ ") • ∅38mm (1 ¹ / ₂ ")
Orbit	∅30mm (1 ³ / ₁₆ ") • ∅38mm (1 ¹ / ₂ ")
Discus	∅30mm (1 ³ / ₁₆ ") • ∅38mm (1 ¹ / ₂ ")
Jewel	∅30mm (1 ³ / ₁₆ ") • ∅38mm (1 ¹ / ₂ ")
Flute	∅30mm (1 ³ / ₁₆ ") • ∅38mm (1 ¹ / ₂ ")
Squat Globe	∅30mm (1 ³ / ₁₆ ") • ∅38mm (1 ¹ / ₂ ")
Globe	∅30mm (1 ³ / ₁₆ ") • ∅38mm (1 ¹ / ₂ ")
Ribbed Globe	∅30mm (1 ³ / ₁₆ ") • ∅38mm (1 ¹ / ₂ ")
Charm	∅30mm (1 ³ / ₁₆ ") • ∅38mm (1 ¹ / ₂ ")
Templar	∅30mm (1 ³ / ₁₆ ") • ∅38mm (1 ¹ / ₂ ")
Crystal Templar	∅38mm (1 ¹ / ₂ ")

FLOAT

POLES



FINISHES Shades @@@ Cloud • Alabaster • Bone • Barley • Dusk • Ceramic • Cream • Mineral • Dove • Parchment • Oatmeal • Millstone • Stone • Clay • Grey Moss
 Slate • Cocoa • Moss • Damson • Smoke • Frame Grey • Lead • Earth • Burnt Ash • Flint • Chacoal • Raven
 Coat Options **Metallics** @@ Platinum • Champagne • Gold • Cognac • Antique Brass • Gunmetal • Pewter • Bronzed
Anodic Metals Twilight • Glow • Sky • Sunrise • Storm • Glimmer • Sunset • Night Sky • Midnight
Custom See page 15 for details
 Matte @
 Satin @
 Gloss @

30mm (1³/₁₆"

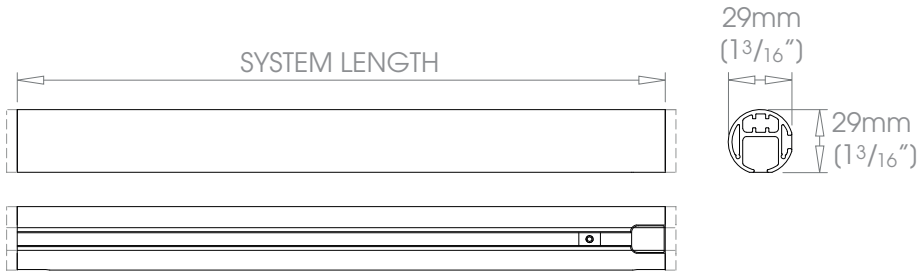

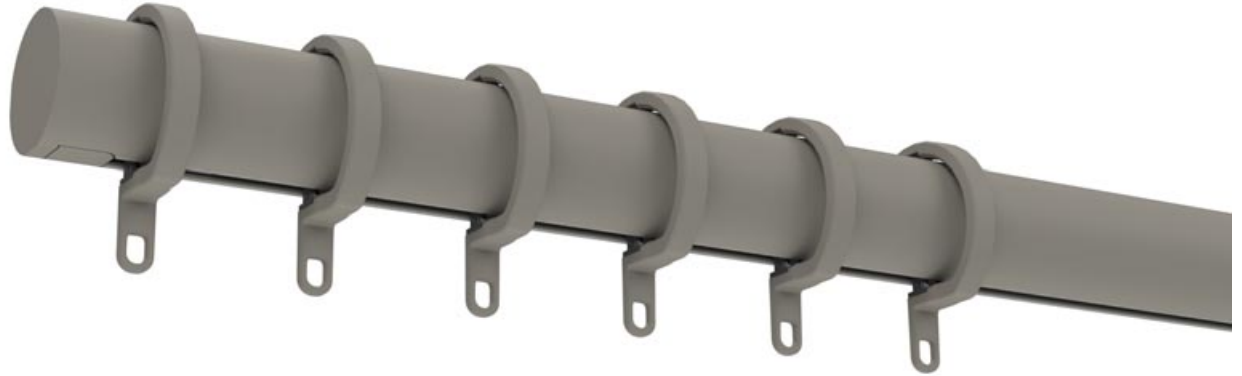

FINISHES Shades @@@ Cloud • Alabaster • Bone • Barley • Dusk • Ceramic • Cream • Mineral • Dove • Parchment • Oatmeal • Millstone • Stone • Clay • Grey Moss
 Slate • Cocoa • Moss • Damson • Smoke • Frame Grey • Lead • Earth • Burnt Ash • Flint • Chacoal • Raven
 Coat Options **Metallics** @@ Platinum • Champagne • Gold • Cognac • Antique Brass • Gunmetal • Pewter • Bronzed
Anodic Metals Twilight • Glow • Sky • Sunrise • Storm • Glimmer • Sunset • Night Sky • Midnight
Custom See page 15 for details
 Matte @
 Satin @
 Gloss @

38mm (1 1/2")

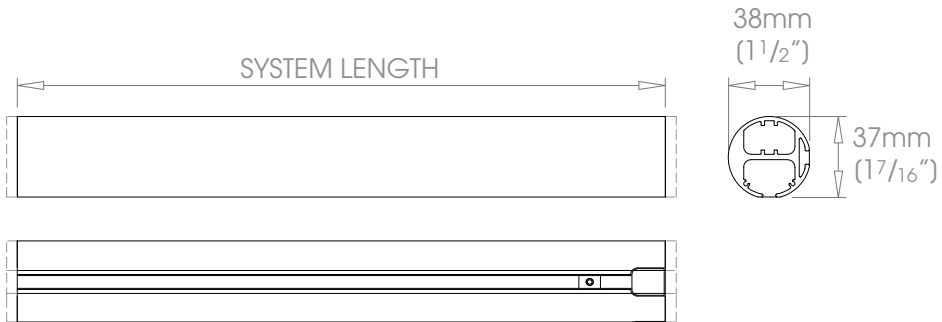



! Return bends are not available.

FINISHES Shades @@@ Cloud • Alabaster • Bone • Barley • Dusk • Ceramic • Cream • Mineral • Dove • Parchment • Oatmeal • Millstone • Stone • Clay • Grey Moss
 Slate • Cocoa • Moss • Damson • Smoke • Frame Grey • Lead • Earth • Burnt Ash • Flint • Chacoal • Raven
 Coat Options **Metallics** @@ Platinum • Champagne • Gold • Cognac • Antique Brass • Gunmetal • Pewter • Bronzed
Anodic Metals Twilight • Glow • Sky • Sunrise • Storm • Glimmer • Sunset • Night Sky • Midnight
Custom See page 15 for details
 Matte @
 Satin @
 Gloss @

30mm (1³/₁₆"

38mm (1¹/₂"

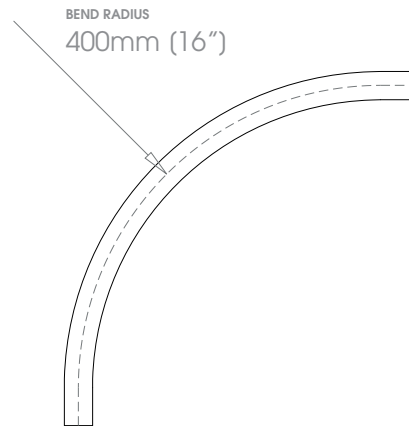
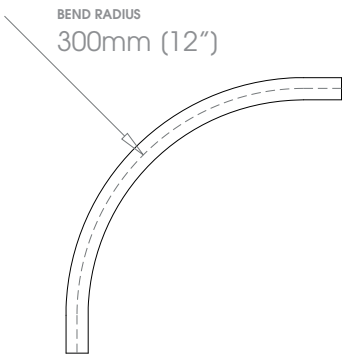



FINISHES **Shades** ☉☉☉ Cloud • Alabaster • Bone • Barley • Dusk • Ceramic • Cream • Mineral • Dove • Parchment • Oatmeal • Millstone • Stone • Clay • Grey Moss
 Slate • Cocoa • Moss • Damson • Smoke • Frame Grey • Lead • Earth • Burnt Ash • Flint • Chacoal • Raven
Coat Options **Metallics** ☉☉ Platinum • Champagne • Gold • Cognac • Antique Brass • Gunmetal • Pewter • Bronzed
Anodic Metals Twilight • Glow • Sky • Sunrise • Storm • Glimmer • Sunset • Night Sky • Midnight
Custom See page 15 for details
Matte ☉
Satin ☉
Gloss ☉

30mm (1³/₁₆")

38mm (1¹/₂")

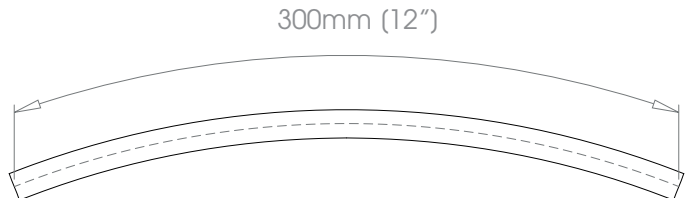
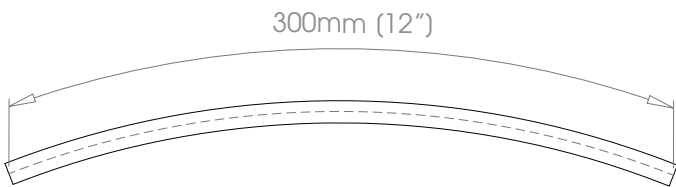

FLOAT

BRACKETS



For custom brackets see page 8

FINISHES **Shades** ☺☺☺ Cloud • Alabaster • Bone • Barley • Dusk • Ceramic • Cream • Mineral • Dove • Parchment • Oatmeal • Millstone • Stone • Clay • Grey Moss
Coat Options **Metallics** ☺☺ Platinum • Champagne • Gold • Cognac • Antique Brass • Gunmetal • Pewter • Bronzed
Anodic Metals Twilight • Glow • Sky • Sunrise • Storm • Glimmer • Sunset • Night Sky • Midnight
Custom See page 15 for details
 Matte ☺
 Satin ☺
 Gloss ☺

30mm (1 3/16")

38mm (1 1/2")

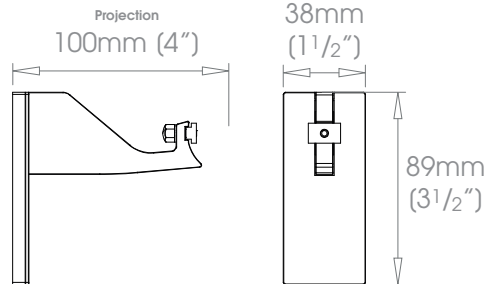
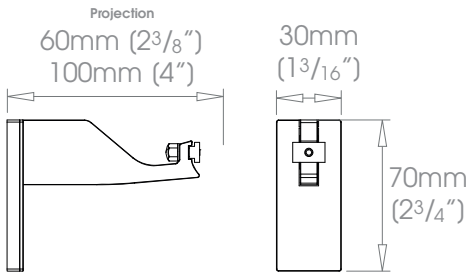



For custom brackets see page 8

FINISHES **Shades** ☉☉☉ Cloud • Alabaster • Bone • Barley • Dusk • Ceramic • Cream • Mineral • Dove • Parchment • Oatmeal • Millstone • Stone • Clay • Grey Moss
 Slate • Cocoa • Moss • Damson • Smoke • Frame Grey • Lead • Earth • Burnt Ash • Flint • Chacoal • Raven
Coat Options **Metallics** ☉☉ Platinum • Champagne • Gold • Cognac • Antique Brass • Gunmetal • Pewter • Bronzed
Anodic Metals Twilight • Glow • Sky • Sunrise • Storm • Glimmer • Sunset • Night Sky • Midnight
Custom See page 15 for details
 Matte ☉
 Satin ☉
 Gloss ☉

30mm (1³/₁₆"

38mm (1¹/₂"

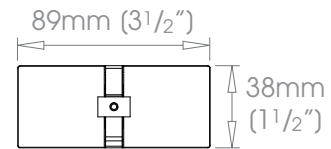
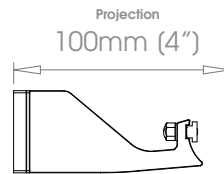
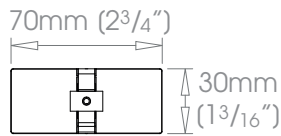
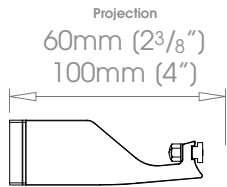



For custom brackets see page 8

FINISHES **Shades** ☉☉☉ Cloud • Alabaster • Bone • Barley • Dusk • Ceramic • Cream • Mineral • Dove • Parchment • Oatmeal • Millstone • Stone • Clay • Grey Moss
 Slate • Cocoa • Moss • Damson • Smoke • Frame Grey • Lead • Earth • Burnt Ash • Flint • Chacoal • Raven
Coat Options **Metallics** ☉☉ Platinum • Champagne • Gold • Cognac • Antique Brass • Gunmetal • Pewter • Bronzed
Anodic Metals Twilight • Glow • Sky • Sunrise • Storm • Glimmer • Sunset • Night Sky • Midnight
Custom See page 15 for details
 Matte ☉
 Satin ☉
 Gloss ☉

30mm (1³/₁₆")

38mm (1¹/₂")

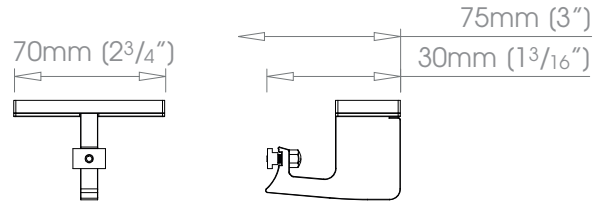
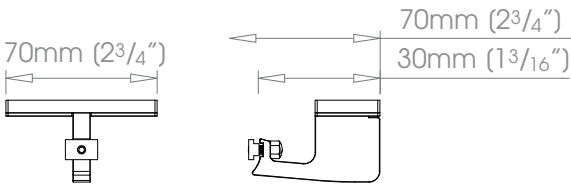

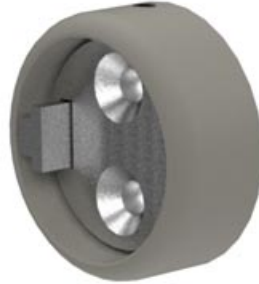

FINISHES Shades @@@ Cloud • Alabaster • Bone • Barley • Dusk • Ceramic • Cream • Mineral • Dove • Parchment • Oatmeal • Millstone • Stone • Clay • Grey Moss
 Slate • Cocoa • Moss • Damson • Smoke • Frame Grey • Lead • Earth • Burnt Ash • Flint • Chacoal • Raven
 Coat Options **Metallics** @@ Platinum • Champagne • Gold • Cognac • Antique Brass • Gunmetal • Pewter • Bronzed
Anodic Metals Twilight • Glow • Sky • Sunrise • Storm • Glimmer • Sunset • Night Sky • Midnight
Custom See page 15 for details
 Matte @
 Satin @
 Gloss @

30mm (1³/₁₆"

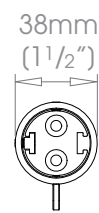
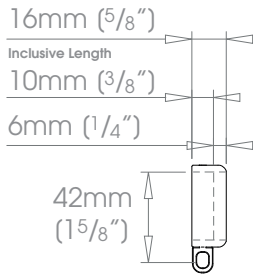

38mm (1¹/₂"

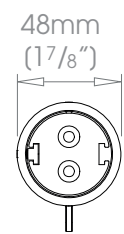
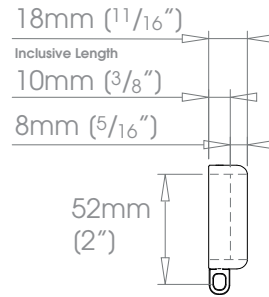

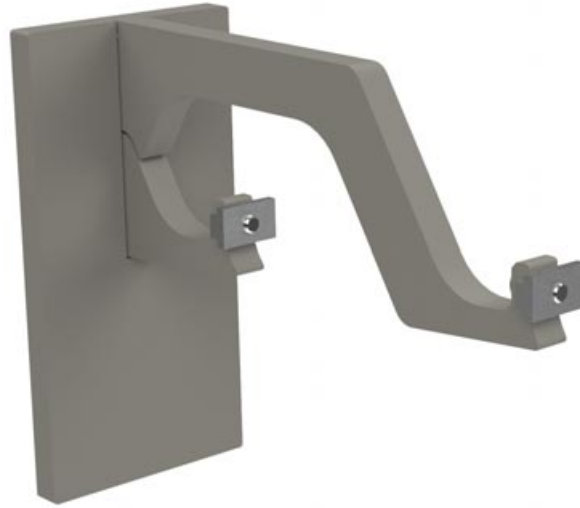

FINISHES Shades @@@ Cloud • Alabaster • Bone • Barley • Dusk • Ceramic • Cream • Mineral • Dove • Parchment • Oatmeal • Millstone • Stone • Clay • Grey Moss
 Slate • Cocoa • Moss • Damson • Smoke • Frame Grey • Lead • Earth • Burnt Ash • Flint • Chacoal • Raven
 Coat Options **Metallics** @@ Platinum • Champagne • Gold • Cognac • Antique Brass • Gunmetal • Pewter • Bronzed
Anodic Metals Twilight • Glow • Sky • Sunrise • Storm • Glimmer • Sunset • Night Sky • Midnight
Custom See page 15 for details
 Matte @
 Satin @
 Gloss @

F30mm (1³/₁₆") B30mm (1³/₁₆")

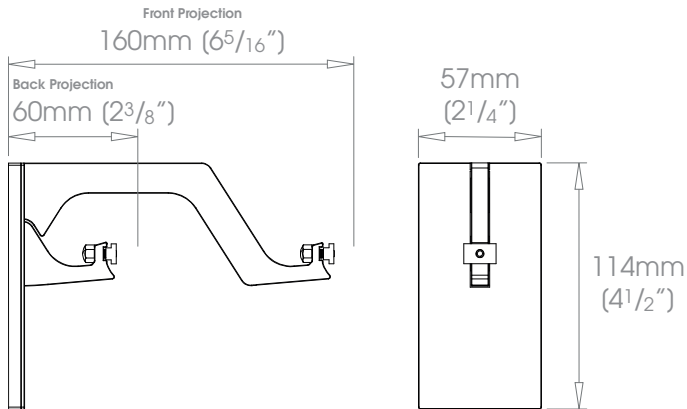

F38mm (1¹/₂") B30mm (1³/₁₆")

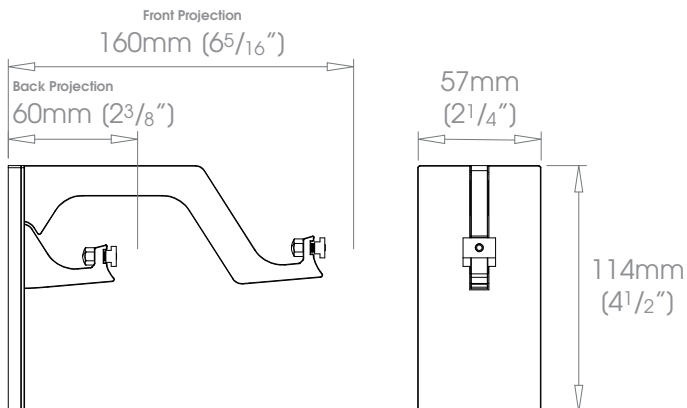

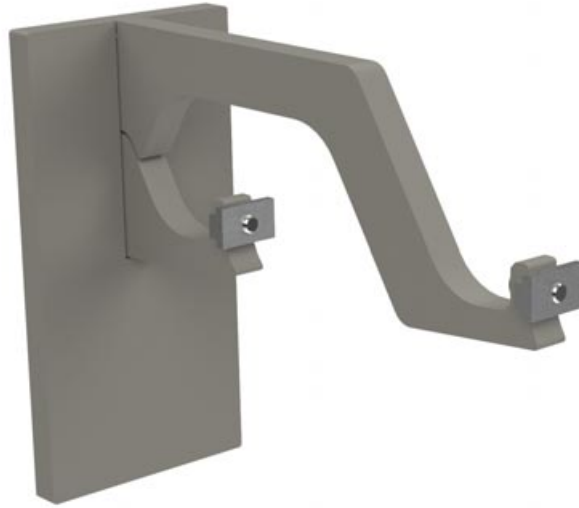

FINISHES **Shades** ☉☉☉ Cloud • Alabaster • Bone • Barley • Dusk • Ceramic • Cream • Mineral • Dove • Parchment • Oatmeal • Millstone • Stone • Clay • Grey Moss
Coat Options **Metallics** ☉☉ Platinum • Champagne • Gold • Cognac • Antique Brass • Gunmetal • Pewter • Bronzed
Anodic Metals Twilight • Glow • Sky • Sunrise • Storm • Glimmer • Sunset • Night Sky • Midnight
Custom See page 15 for details
 Matte ☉
 Satin ☉
 Gloss ☉

F38mm (1 1/2") B38mm (1 1/2")

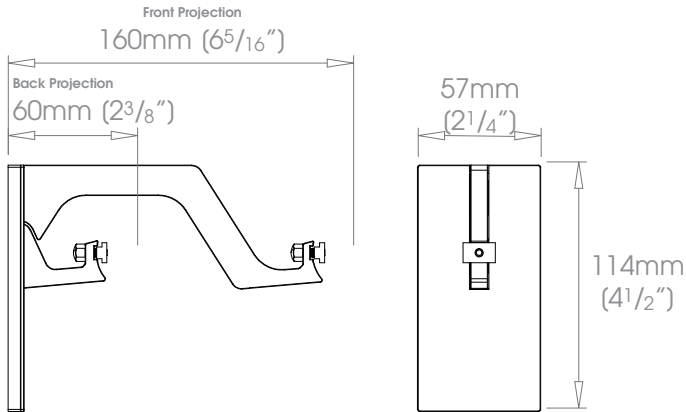



FINISHES Shades @@@ Cloud • Alabaster • Bone • Barley • Dusk • Ceramic • Cream • Mineral • Dove • Parchment • Oatmeal • Millstone • Stone • Clay • Grey Moss
 Slate • Cocoa • Moss • Damson • Smoke • Frame Grey • Lead • Earth • Burnt Ash • Flint • Chacoal • Raven
 Coat Options **Metallics** @@ Platinum • Champagne • Gold • Cognac • Antique Brass • Gunmetal • Pewter • Bronzed
Anodic Metals Twilight • Glow • Sky • Sunrise • Storm • Glimmer • Sunset • Night Sky • Midnight
Custom See page 15 for details
 Matte @
 Satin @
 Gloss @

F30mm (1³/₁₆") B30mm (1³/₁₆")

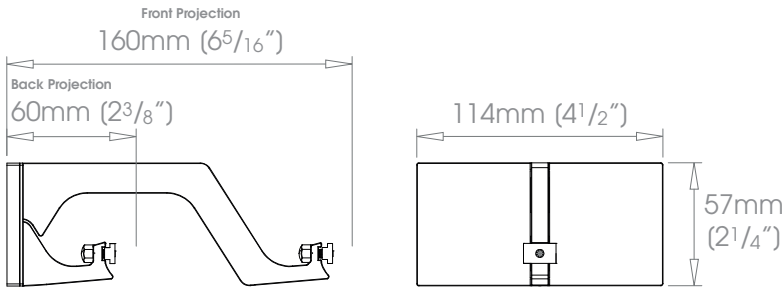

F38mm (1¹/₂") B30mm (1³/₁₆")

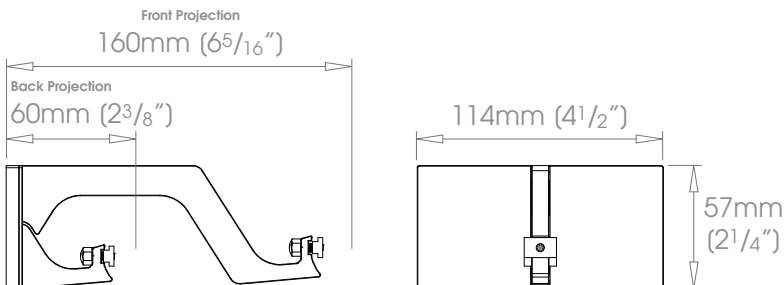



FINISHES **Shades** ☉☉☉ Cloud • Alabaster • Bone • Barley • Dusk • Ceramic • Cream • Mineral • Dove • Parchment • Oatmeal • Millstone • Stone • Clay • Grey Moss
 Slate • Cocoa • Moss • Damson • Smoke • Frame Grey • Lead • Earth • Burnt Ash • Flint • Chacoal • Raven
Coat Options **Metallics** ☉☉ Platinum • Champagne • Gold • Cognac • Antique Brass • Gunmetal • Pewter • Bronzed
Anodic Metals Twilight • Glow • Sky • Sunrise • Storm • Glimmer • Sunset • Night Sky • Midnight
Custom See page 15 for details
Matte ☉
Satin ☉
Gloss ☉

F38mm (1 1/2") B38mm (1 1/2")

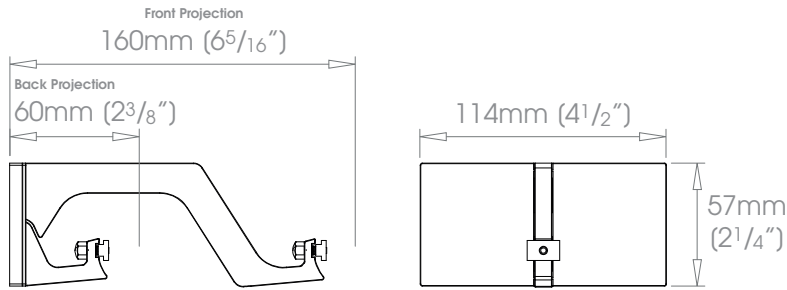

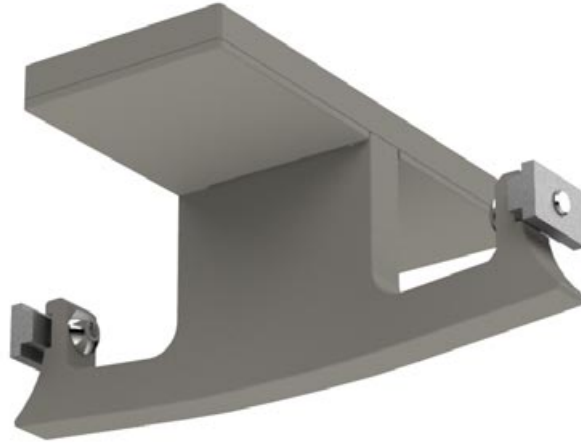

FINISHES Shades @@@ Cloud • Alabaster • Bone • Barley • Dusk • Ceramic • Cream • Mineral • Dove • Parchment • Oatmeal • Millstone • Stone • Clay • Grey Moss
 Slate • Cocoa • Moss • Damson • Smoke • Frame Grey • Lead • Earth • Burnt Ash • Flint • Chacoal • Raven
 Coat Options **Metallics** @@ Platinum • Champagne • Gold • Cognac • Antique Brass • Gunmetal • Pewter • Bronzed
Anodic Metals Twilight • Glow • Sky • Sunrise • Storm • Glimmer • Sunset • Night Sky • Midnight
Custom See page 15 for details
 Matte @
 Satin @
 Gloss @

F30mm (1³/₁₆") B30mm (1³/₁₆")

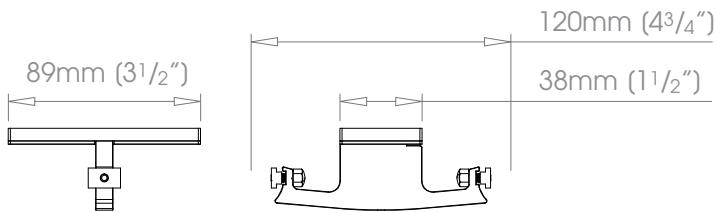

F38mm (1¹/₂") B38mm (1¹/₂")

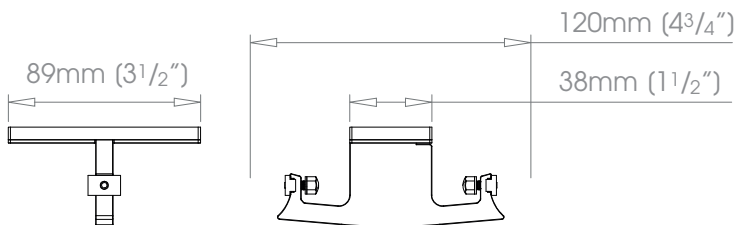

FLOAT

RINGS



i Ring will be supplied in Gypsum or Anthracite Glider see page 16

FINISHES **Shades** ☺☺☺ Cloud • Alabaster • Bone • Barley • Dusk • Ceramic • Cream • Mineral • Dove • Parchment • Oatmeal • Millstone • Stone • Clay • Grey Moss
 Slate • Cocoa • Moss • Damson • Smoke • Frame Grey • Lead • Earth • Burnt Ash • Flint • Chacoal • Raven
Coat Options **Metallics** ☺☺ Platinum • Champagne • Gold • Cognac • Antique Brass • Gunmetal • Pewter • Bronzed
Anodic Metals Twilight • Glow • Sky • Sunrise • Storm • Glimmer • Sunset • Night Sky • Midnight
Custom See page 15 for details
Matte ☺
Satin ☺
Gloss ☺

30mm (1³/₁₆"

38mm (1¹/₂"

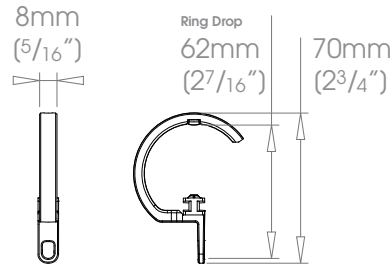
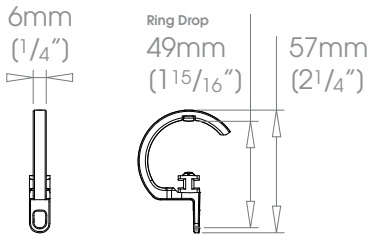

FLOAT

ACCESSORIES



FINISHES Shades @@@ Cloud • Alabaster • Bone • Barley • Dusk • Ceramic • Cream • Mineral • Dove • Parchment • Oatmeal • Millstone • Stone • Clay • Grey Moss
 Slate • Cocoa • Moss • Damson • Smoke • Frame Grey • Lead • Earth • Burnt Ash • Flint • Chacoal • Raven
 Coat Options **Metallics** @@ Platinum • Champagne • Gold • Cognac • Antique Brass • Gunmetal • Pewter • Bronzed
Anodic Metals Twilight • Glow • Sky • Sunrise • Storm • Glimmer • Sunset • Night Sky • Midnight
Custom See page 15 for details
 Matte @
 Satin @
 Gloss @

Small

Grand

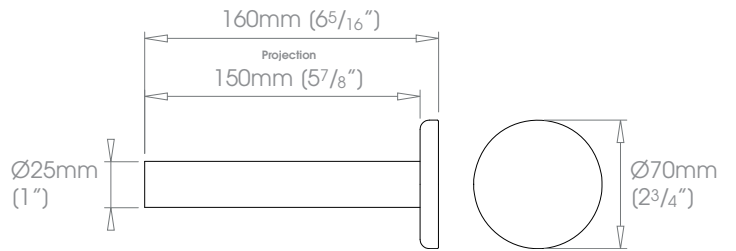
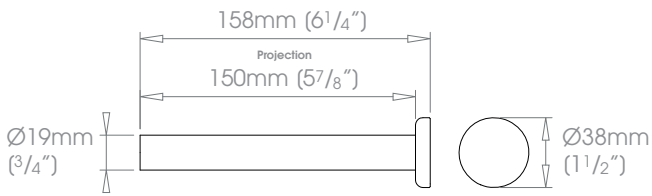



FINISHES Shades @@@ Cloud • Alabaster • Bone • Barley • Dusk • Ceramic • Cream • Mineral • Dove • Parchment • Oatmeal • Millstone • Stone • Clay • Grey Moss
Slate • Cocoa • Moss • Damson • Smoke • Frame Grey • Lead • Earth • Burnt Ash • Flint • Chacoal • Raven
Coat Options **Metallics** @@ Platinum • Champagne • Gold • Cognac • Antique Brass • Gunmetal • Pewter • Bronzed
Anodic Metals Twilight • Glow • Sky • Sunrise • Storm • Glimmer • Sunset • Night Sky • Midnight
Custom See page 15 for details
Matte @
Satin @
Gloss @

Seamless

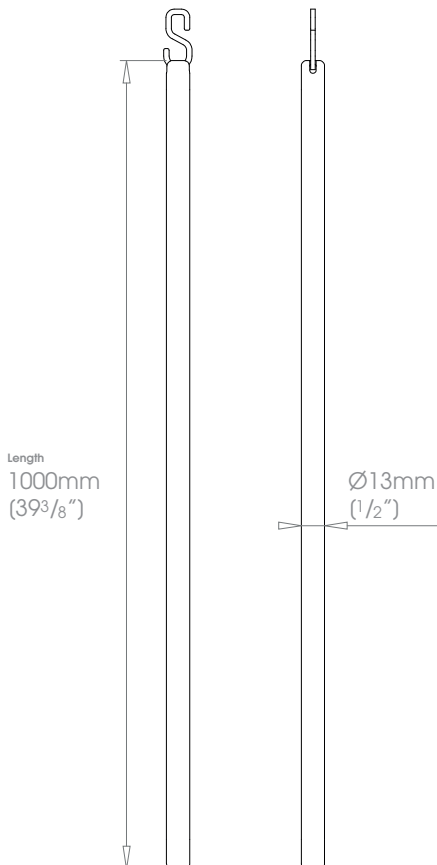

CONTACT

www.bradleycollection.com



UK & REST OF THE WORLD

+44 (0)1449 722 724
info@bradleycollection.com

USA & CANADA

+1 (310) 815 8255
info.us@bradleycollection.com

LONDON SHOWROOM

+44 (0)207 871 7793
showroom@studiotwochelsea.com

THE BRADLEY COLLECTION



Industry Partner
Supporting the interior design profession

CEDIA
MEMBER

Specialised fixings for mounting brackets will be required in certain situations and are not provided as standard. Steel items are not recommended for damp conditions such as shower rooms. Crystal finials should not be positioned in direct sunlight, and are not suitable for use in conservatories. Fluid Metal items are supplied unlacquered and will tarnish over time.

The Bradley Collection reserves the right to modify design and materials without prior notice as part of a process of continual product improvement. Due to printing limitations, colours in this brochure may not be accurate.

Products are protected by Design Rights, under provisions of Copyright, Designs & Patents Act 1988. Bradley®, The Bradley Collection® and  Logo are registered Community trademarks of The Bradley Collection Ltd. in Europe and registered trademarks of the Bradley Collection, Inc. in the USA.

The Bradley Collection Ltd Lion Barn • Maitland Road • Needham Market • Suffolk • IP6 8NS • UK